

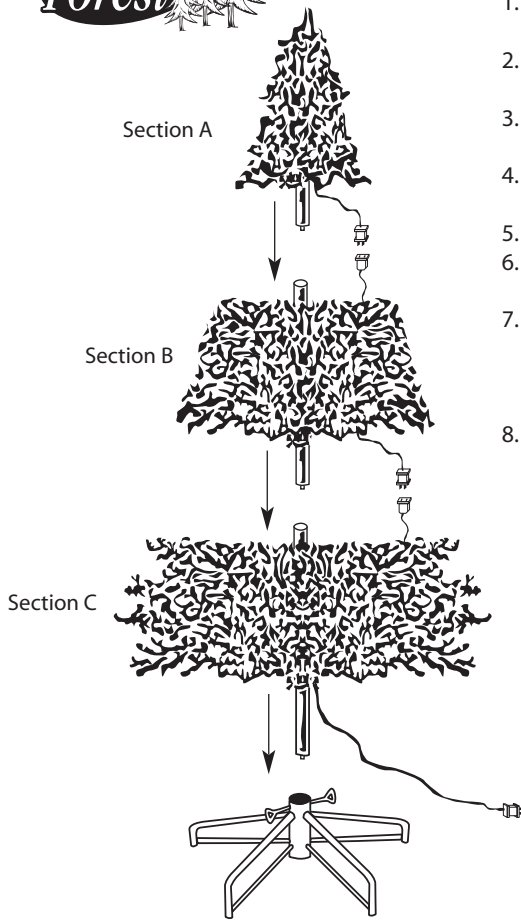

BASIC TREE ASSEMBLY FOR PRE-LIT TREES

HINGED BRANCHES



1. Before you start to assemble your tree, choose a location that is level and near a dedicated wall outlet.
2. Locate the tree stand and pull apart the legs so that they form a "X" shape. Lock the stand in position with the single eye bolt on the outside metal tab.
3. Start to screw the three eyebolts into the stand. Be sure not to screw all the way in so the pole from Section C will fit.
4. Carefully insert Section C of the tree into assembled stand. Make sure pole is firmly inserted into stand and tighten the eyebolts on the stand till they touch the trunk.
5. Insert the pole of Section B into Section C and do the same with Section A into Section B.
6. Allow branches to fall into place or gently pull up and out. When adjusting branches be sure that all wires are free of the branch hinges.
7. Connect the plug(s) from each section into the section below securely. Plug the cord into your wall outlet. Your entire tree should be lit. If some bulbs do not light, search for any loose plugs, broken, loose or missing bulbs. (See trouble shooting section.) Keep tree plugged in while shaping your tree. Should a light flicker, check for the bulb(s) that may have caused the trouble.
8. Begin to shape the branches from bottom to the top. Slightly upsweep all branch tips for a uniform look.

STORAGE

1. Unplug cord from the wall outlet and remove all ornaments and decorations.
2. Check Tree for any broken bulbs and tape them to find them later.
3. Unplug each section, keep each stack of lights in section connected together.
4. Gently lift off the top and middle sections and remove the bottom section from the stand.
5. Carefully place the tree back in its box and tape it shut.

DO NOT STORE TREE IN A DAMP AREA OR IN AN AREA WHERE THE TEMPERATURE EXCEEDS 100°F.

SAVE THESE INSTRUCTIONS

TROUBLE SHOOTING

If Lights Do Not Work

1. Check whether the cord is properly plugged into the outlet.
2. Be sure there is power to the outlet.
3. Check whether all plugs within the tree are securely connected.
4. Check whether all bulbs are tightly fixed inside the lamp holders.
5. If a bulb is blown, replace the faulty bulb following the below diagram.
There are spare bulbs included for easy replacement.

TO REMOVE

Gently grasp and pull bulb upwards while holding socket firmly.

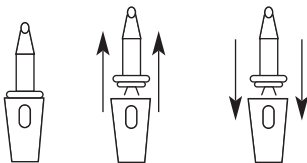

TO REPLACE

Align base of lamp with the hole on socket and push until firmly seated. Do not twist the replacement bulb when inserting or the entire set may not light.

6. If none of the lights are working, check the fuse in plug of the light string. If fuse is blown, replace the fuse following the diagram below. There are spare fuses included for easy replacement.

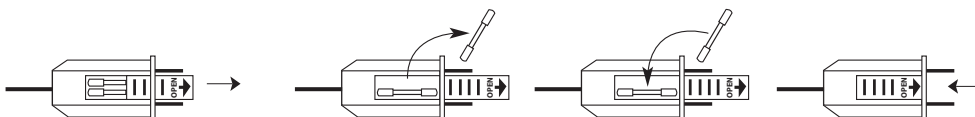

To Remove:
Gently slide cover open.

Lift blown fuse out of the socket

To Replace:
Place new fuse into empty socket.

Gently close cover.

WARNING

Risk of Fire and Electric Shock

1. Read all instructions and warning tags included with this tree.
2. For Indoor Use Only, unless specified for Outdoor Use.
3. Do not place near gas or electric heaters, radiators, fireplaces, candles or other similar sources of heat.
4. Place on a level, hard, flat surface; do not place tree where it is likely to wobble due to uneven floor or thick carpeting.
5. Do not use candles on tree.
6. After assembling the tree and adding decorations, make sure tree remains stable. If tree is not stable, shift the weight of the decorations and use support wires to walls and/or window frames (make sure they are secure also).
7. Do not overload extension cords or power strips, see rating on those devices and check the rating label of the tree for compatibility.
8. Do not install near fountains, bathtubs, sinks or other wet areas.

Sterling, Inc
Kansas City, MO
www.sterling-inc.com