

Have Cover Questions? Call 888-352-7582

Hours: 8AM – 5PM Central

Our Safety Covers ARE CERTIFIED-SAFE! Most OTHERS ARE NOT!



If you live in a climate in which the leaves fall off of the trees and/or the pool needs to be winterized; the pool should have a Winter Pool Cover. The Best is a Certified-SAFE Safety Cover which is available in Mesh or Solid Material. All of our Safety Covers meet the rigid ASTM testing standards. Which means our covers are the strongest in the industry. Don't you want the Best to Protect Your Pool and Most Importantly Your Family?

The following four pages should be filled out as completely and accurately as possible in order to assure the Certified-SAFE Safety Cover is made to fit properly.

You may return this form to us in any one of two ways:

1. Email to SafetyCovers@propools.com

2. Mail: Propools
c/o Safety Covers
6213 Charlotte Pike
Suite 115
Nashville, TN 37209

It is always best if you can send to us a sketched drawing of your pool and the five foot area directly around the edge of your pool. If you would like to send us a digital image or two of your pool area, just email them to the Email address above.

Ship To: _____ DATE _____
 NAME _____
 STREET _____
 CITY/STATE _____
 PHONE # _____ ZIP _____
 E-MAIL _____



Complete the sections which apply, otherwise leave blank.

- Mesh Solid
- Emperor
 King
 Royal
 Dura-Mesh
 SmartMesh
 (Other) _____

ANCHOR/DECK TYPE

- CONCRETE
 WOOD DECK
 PAVERS

POOL CORNER TYPE & SIZE
 IF POOL CORNERS ARE GREATER
 THAN 2' RADIUS OR DIAGONAL.
 PLEASE SPECIFY THE TYPE AND SIZE.

***SKETCH IN STEP
 LOCATION AND
 STEP DIMENSIONS
 (SIZE & LOCATION)***

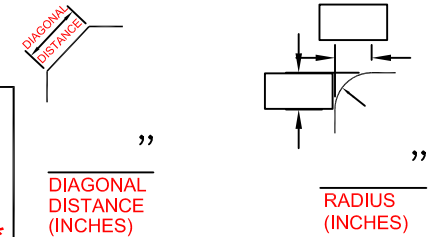

*DIRECTION IS DETERMINED BY
 STANDING IN SHALLOW END*

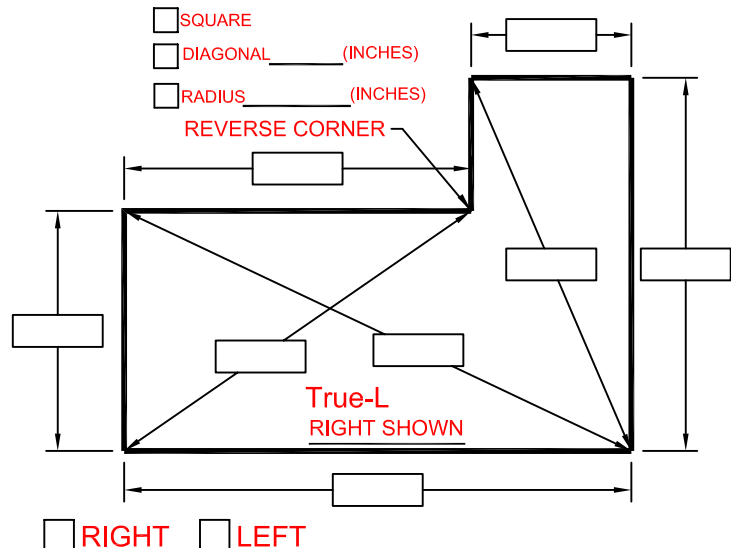
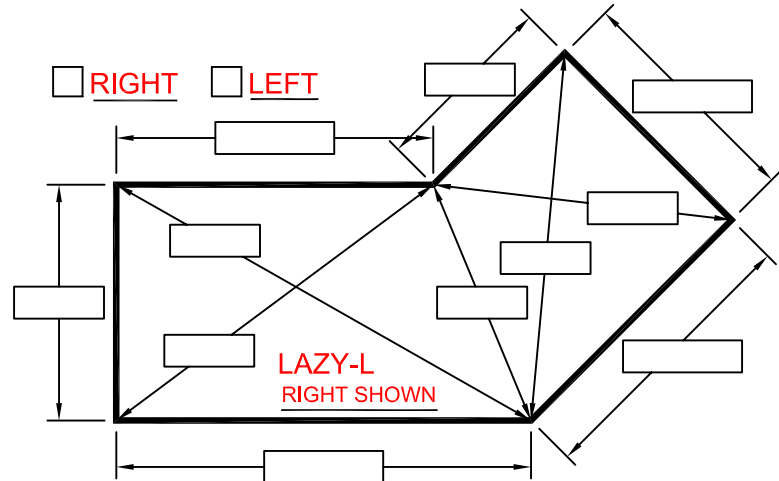
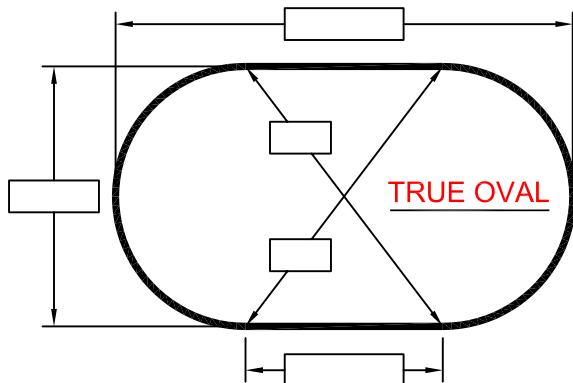
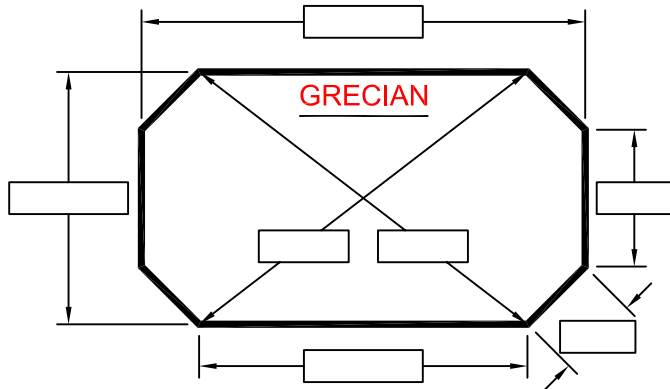
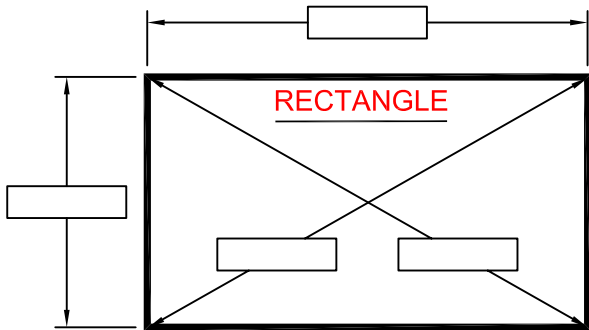

1. Begin with a freehand sketch indicating inside pool dimensions. The sketch should include pool orientation and the "A-B" line location. Include deck area, and any obstructions within 3' of the waterline.

A photo of the pool is needed when rocks, spas or anything out of the ordinary exists. It's recommended to take pictures of the numbered points at obstructions.

2. Establish two points, "A-B" with "A" on the left as shown. The "A-B" line must be 3' away from the pool and 2/3 the length of the pool; 20'-25' is typical (show this on the sketch). To mark "A-B" points on deck - use chalk marks, on ground - use stakes in the dirt. Do not remove the "A-B" points until the measurements have been confirmed and approved. NOTE: The "A-B" line must never cross the pool line and should be approximately 3' away from the pool at the closest point (4' to 5' away from pools over 44' long).

3. Using chalk, mark and number points along the inside edge of the pool at approximately 2' intervals. Number all corner points, ladders, handrails, grabrails, slide legs, rocks, spillways, spa walls separating spa and pool, fill spout and dive stand. 1' intervals should be used in small or tight radius areas. At least 3 points along straight walls.

4. Measurements are now taken from point "A" to #1, then point #2, and all the way around the pool. Then measure from point "B" to same point #1 and then #2, as you did for point "A". Measurements are listed in column format as shown.

5. Take measurements between two known points to determine length and width cross dimensions of the pool. Cross dimensions to any raised beam obstacles are recommended.

NO.	A	B
1	25'-2"	20'-8"
2	26'-10"	19'-3"
3	28'-5"	18'-6"
4	30'-4"	17'-11"
5		
6	CONTINUE	CONTINUE
7	CONTINUE	CONTINUE
8	CONTINUE	CONTINUE
9	CONTINUE	CONTINUE
10		
11		
12		
13		
14		
15		
16		
17		
18	↓	↓
19		
20		

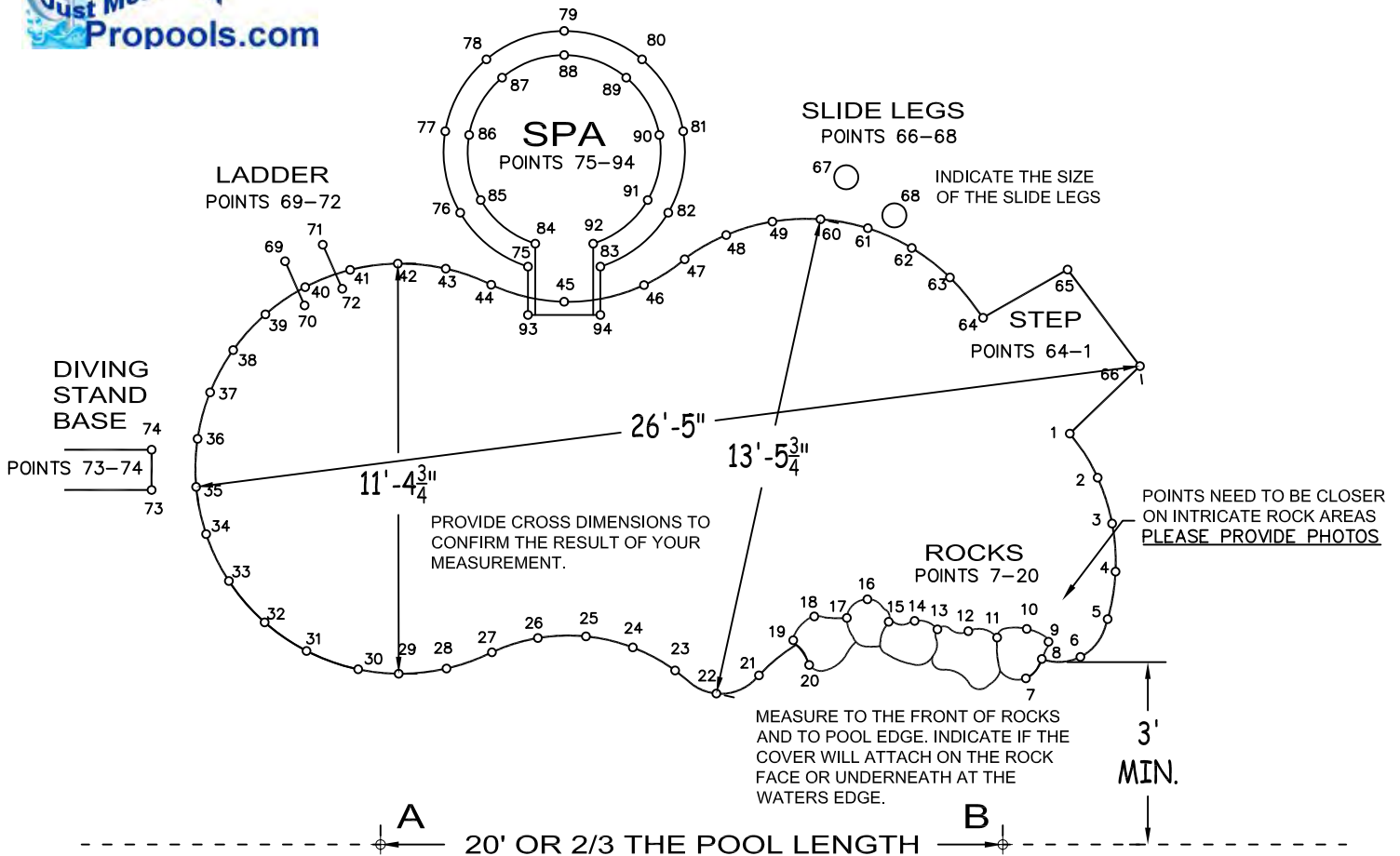

NOTE: MAKE SURE THE A-B LINE IF EXTENDED IS NOT CROSSING THE PERIMETER OF THE POOL.

Any Questions? Call 888-352-7582, or email to SafetyCovers@proools.com for a quote.

NAME: _____

DISTANCE FROM "A" to "B" _____

	A	B
1		
2		
3		
4		
5		
6		
7		
8		
9		
10		
11		
12		
13		
14		
15		
16		
17		

	A	B
18		
19		
20		
21		
22		
23		
24		
25		
26		
27		
28		
29		
30		
31		
32		
33		
34		
35		

	A	B
36		
37		
38		
39		
40		
41		
42		
43		
44		
45		
46		
47		
48		
49		
50		
51		
52		
53		

	A	B
54		
55		
56		
57		
58		
59		
60		
61		
62		
63		
64		
65		
66		
67		
68		
69		
70		
71		

CROSS DIMENSIONS #1: FROM POINT # _____ TO POINT # _____ LENGTH _____
 CROSS DIMENSIONS #2: FROM POINT # _____ TO POINT # _____ LENGTH _____
 CROSS DIMENSIONS #3: FROM POINT # _____ TO POINT # _____ LENGTH _____
 CROSS DIMENSIONS #4: FROM POINT # _____ TO POINT # _____ LENGTH _____

