



PACKAGING

The following accessories will be provided in the box. (fig. 1)

- | | |
|----------------------------|---|
| 1. Skimmer body | 8. Hose connection |
| 2. Skimmer body lid | 9. Flap |
| 3. Frame for skimmer mouth | 10. Bag of screws |
| 4. Face plate embellisher | 11. Return valve (with directional ball, 2 gaskets and nut) |
| 5. 2 Seals | 12. 2 Inlet seals |
| 6. Basket | 13. Inlet nut |
| 7. Suction lid | 14. Clamp |



INSTALLATION

INSTALLATION OF THE SKIMMER AND RETURN VALVE (return inlet)

(1) SKIMMER: Filtration element which should be placed on the outside upper wall of the pool. Its function is to skim the water surface, so that debris is lodged within the skimmer basket or passed on to the filter. If too fine to be retained by the skimmer basket itself.

The pool may be treated with chlorine tablets in the skimmer basket. It is also possible to attach a vac hose to the skimmer suction lid (7).

The skimmer should be positioned opposite the direction of prevailing winds so that any debris is blown towards it (Fig 2)

1. CUTTING THE POOL WALL

The stencil provided should be used to cut around with metal scissors.

Any sharp edges should be filed to avoid damaging the PVC lining, and non-corrosive paint should be applied to protect the cut-out-area.

Follow the same method for the return inlet situated in the lower part of the pool wall (Fig 3).

2. FIXING THE SKIMMER BODY(S) TO THE OUTSIDE POOL WALL

Line up the gaskets with the pre-drilled holes on the outside wall and affix using the sticky pads (P) situated in the corners. Next screw on the skimmer body (1) using the shortest screws from the inside of the pool. Fix on the hose cuff (8), apply ptfе tape and securely thread to the skimmer body (Fig 4).

ATTENTION

Before connecting the hose, read the sections dealing with the positioning and installation of the pump in the filter manual. If a cartridge filter is being used, connect the ball valves (B) as shown in the diagram. Do not forget to put ptfе tape on the threads and to position them in accordance with the directional arrows shown on the valves (Fig. 5) Connect the hose, place ptfе tape on threaded end and thread into the suction side of the filter. Use the clamp (A) to connect the other end to the skimmer hose cuff (8).

NB: It is very important to place ptfе tape on the threads to ensure water-tight fitting.

3. FIXING THE PVC LINER

Carefully follow the instructions for pool assembly.

NB. It is very important that the liner is well-positioned around the pool walls and bottom.

(11) RETURN VALVE (RETURN INLET): Filtered water returned to the pool via this valve thus completes the filtration cycle. This valve contains a small eyeball which allows returned water to be directed to the most appropriate spot for skimmer collection.

4. INSTALLATION OF THE RETURN VALVE (RETURN INLET) (Fig. 6-7)

Begin to fill the pool with water ensuring that the return valve is not covered, by only filling to a distance of 4 cm below the lower body of the inlet. Mark the hole on the liner with a pen and cut a cross within this circle with a sharp knife, being careful not to go over the edge of the circle you have drawn.

From the inside of the pool push the return inlet (11) through the cross with one of the gaskets (12) already in place. The excess liner showing on the external part of the pool should be cut cleanly to size.

The remaining gasket (12) is introduced from the external wall of the pool and will be firmly secured with the return inlet nut (13).

NB. Before proceeding to fill the pool so as to complete the installation of the skimmer, the return inlet (11) and the filter should be affixed to the return valve (11) (apply ptfе tape and thread) and secured with a clamp (14).

5. INSTALLING THE SKIMMER FRAME

Once the hoses have been installed, proceed to fill the pool until it is 4 cm below the lower level of the skimmer mouth. Place the gasket on the inside of the frame by means of the sticky pads (P) so that the frame lines up with the skimmer mouth. (Fig. 8).

Loosely thread the screws through the frame to ensure that everything is correctly lined up.

Do not fully tighten the screws to begin with, do this gradually and uniformly. Screw according to the pattern shown in Fig. 9.

6. FINAL STEPS

Push on the skimmer face plate (4) and fix the skimmer flap (9) (Fig. 10) through the skimmer mouth by pushing it to the two ends.

Place the skimmer basket (6) inside the skimmer, the suction lid (7) and finally the skimmer body lid (2).

1

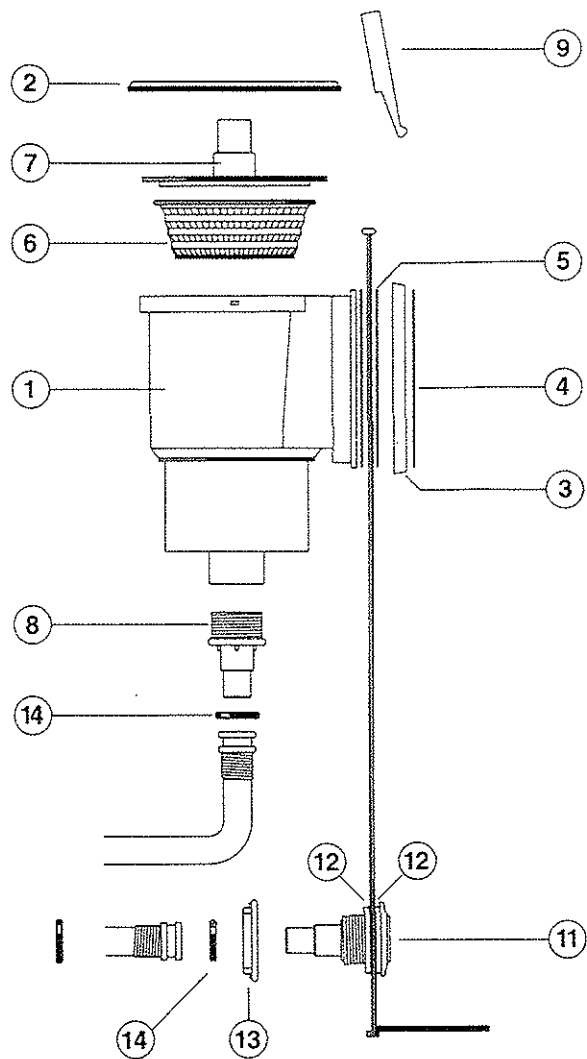

GLISH

	DESCRIPTION	Nº	DESCRIPTION
	Skimmer body	8	Hose connection
	Skimmer body lid	9	Flap
	Frame for skimmer mouth	10	Bag of screws
	Face plate embellisher	11	Return valve
	Seals	12	Inlet seals
	Basket	13	Inlet nut
	Suction Lid	14	Clamp

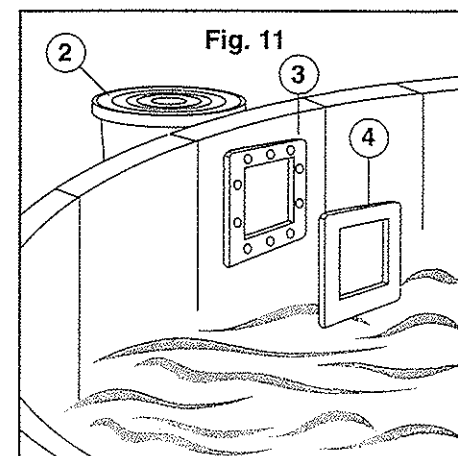
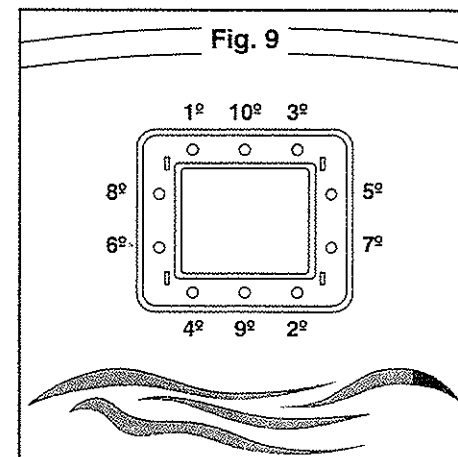
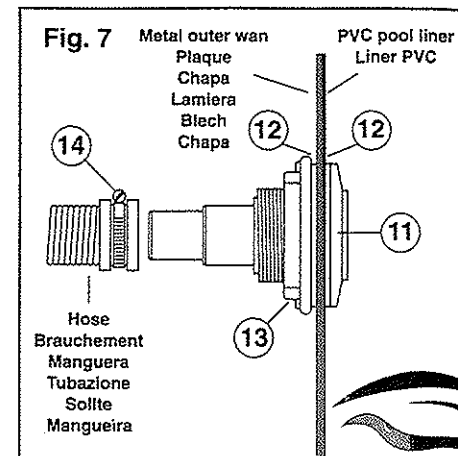
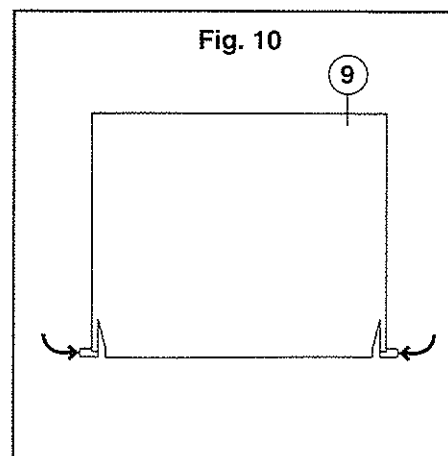
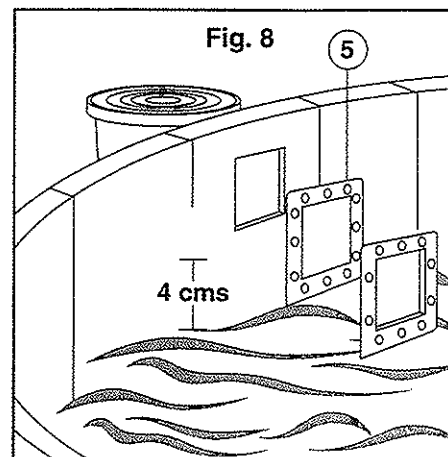
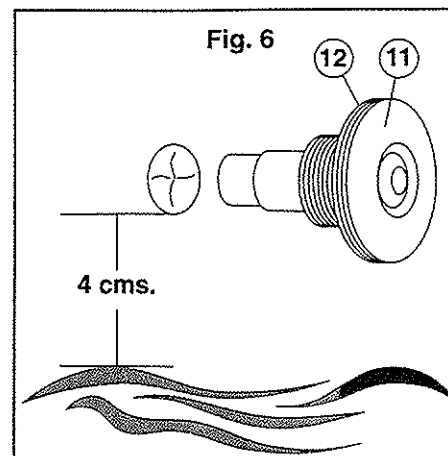

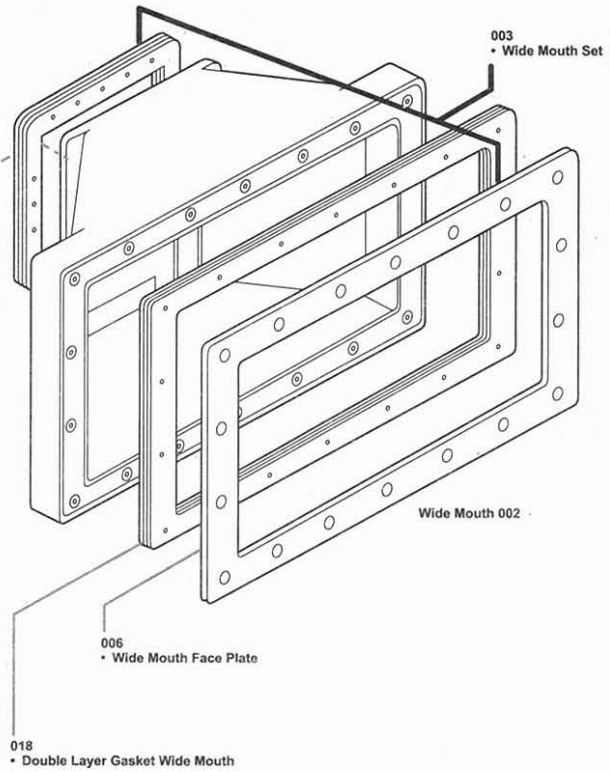
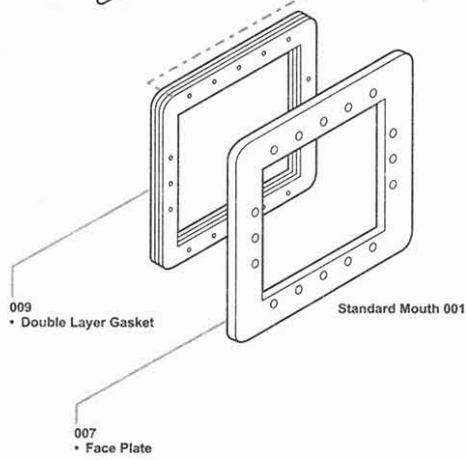
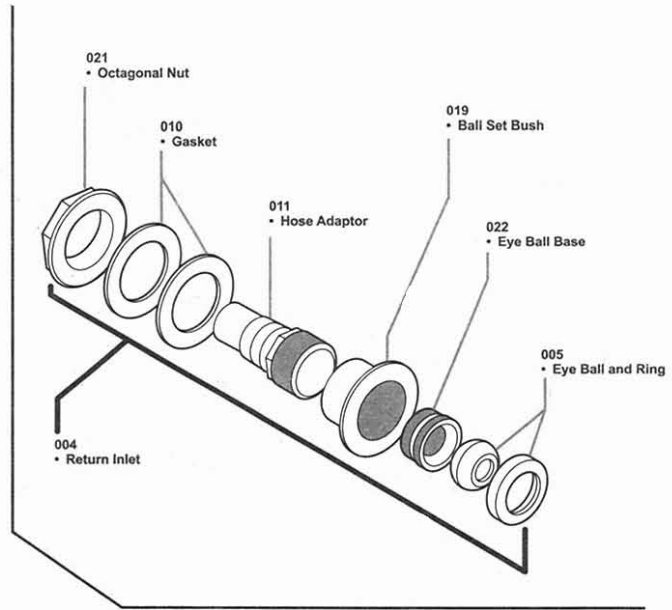
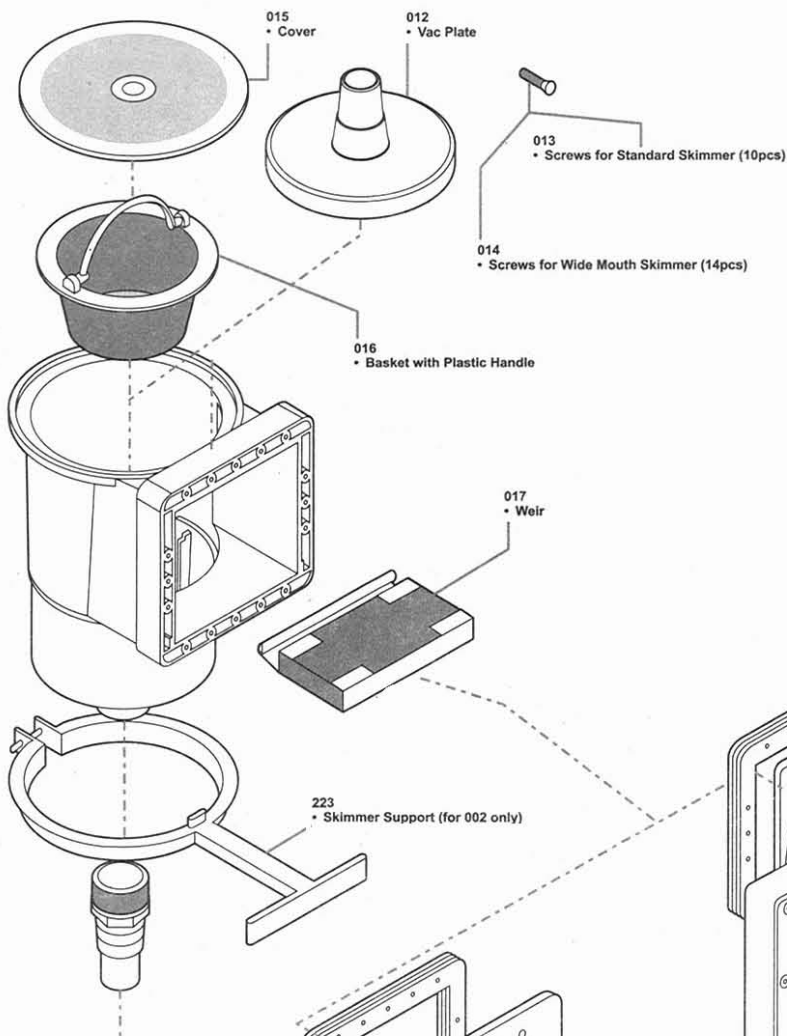

Panel Cut Out Pattern

Units in millimeter (inches)
• Cut Out Standard Mouth Regular 001

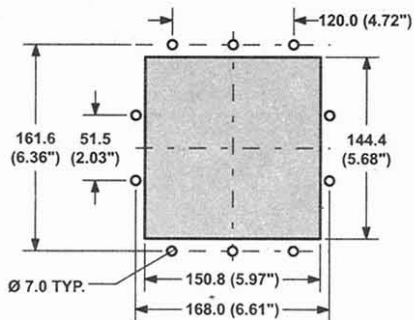

• Cut Out Wide Mouth 002

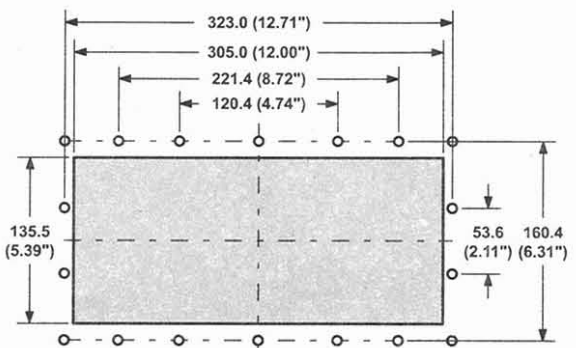

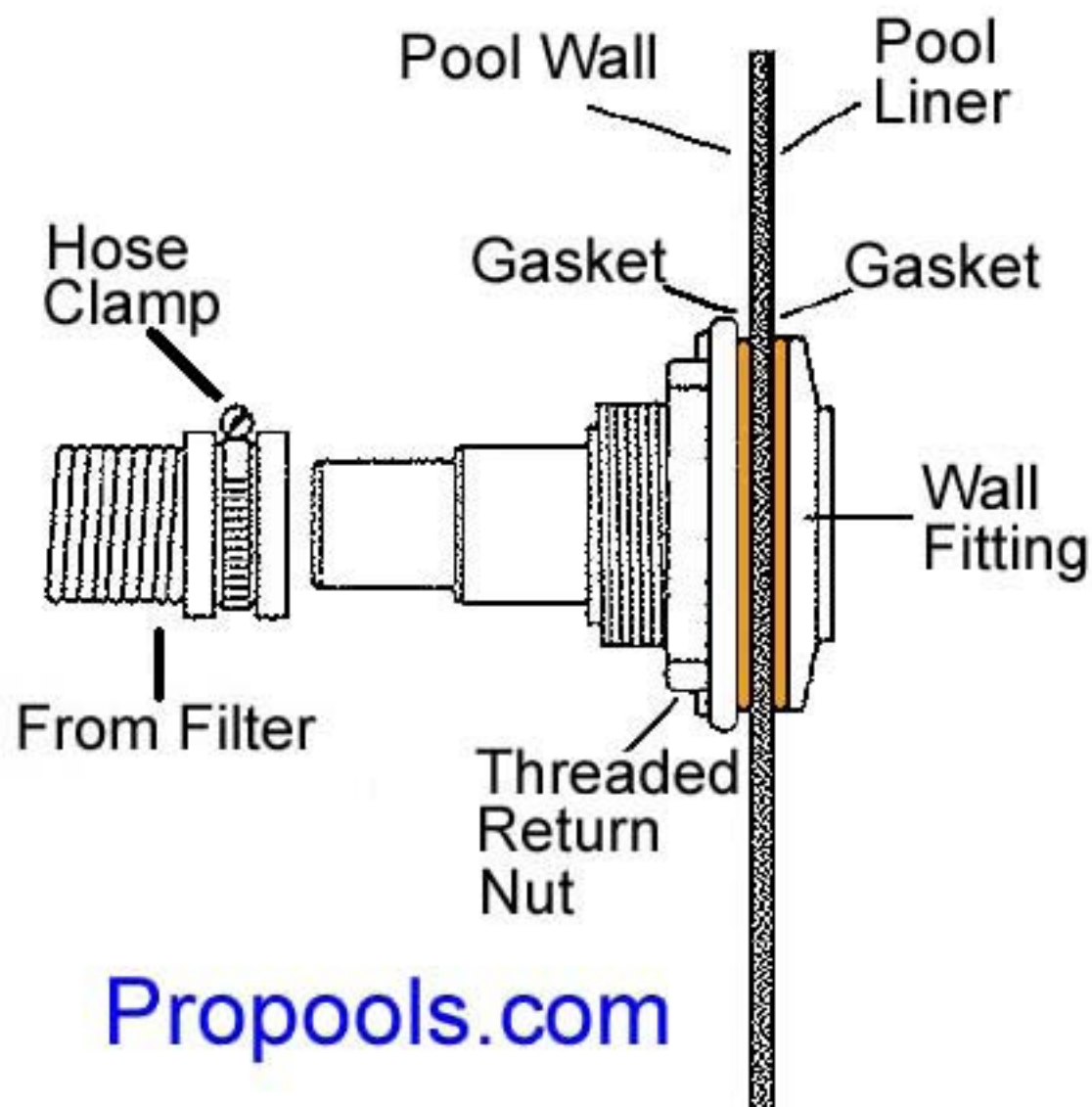

Propools.com