



OWNERS MANUAL GEM-ABGRSK "Gemini" Starter Kit



**WARNING! THOROUGHLY READ ALL INSTRUCTIONS
BEFORE INSTALLING**



Installation - easy "DIY- PLUG & PLAY"

- Remove the Plug & Play Upgraded 96W Transformer with 24 Rail Light Capacity-Cable and 4 Splitter (3-5 Pin/1-4 Pin) Male Connectors and Remote and place close to an approved ground fault receptacle, to plug the Power Adapter into. *Note see image below.

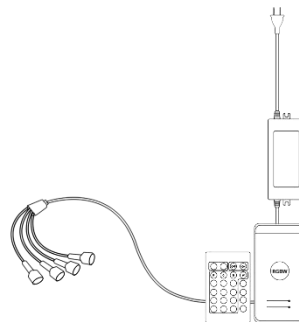

- Remove the 2 Sets of 2 Rail Lights with 10' power cords (Total of 4 Rail Lights and 3M wire clips) from the protective packaging in the box and remove twist ties on the wire (keep twist ties close).
- Find the 2 5-Pin Female Connectors on the end of each Flat Cable, align to the 2 5-Pin Male Connectors from the 4 Splitter and hand tighten the threaded Connectors.
- In different directions on the ground below the top rail around your Above Ground Pool, layout the Flat Cables with 2 Rail Lights on each (Use 3M wire clips as needed to secure wire).
- For the initial setup of your WiFi - Bluetooth NeuTerra Smart system, plug in the Power Adapter to an approved ground fault receptacle and follow the App download steps.

Getting Started

- Download Smart Life-Smart Living App:



Installation Sheet

4pc Smart Rail Lights

IP65 CE 24VDC

Please read these instructions before commencing installation & retain them for future reference. Important information

It is recommended that the 4 Smart Rail Light system are both fully connected to the cable/5-Pin connector on the (Expansion Kit).

- These products are designed for connection to the 24VDC Power Adapter supplied in the (Expansion Kit).
- We will not accept responsibility for any claims arising from a poor installation.

Installation Procedure

- Ensure the 4 Smart Rail Light system are connected to the 24VDC Power Adapter supplied in the (Expansion Kit).
- Fix the garden 4 Smart Rail Light system in the desired position.
- The 4 Smart Rail Light system are suitable for external use, but must not be submerged in water.

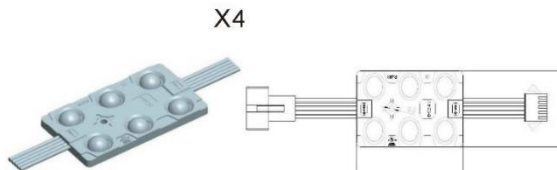

1

SPECIFICATIONS:

- Output Voltage: DC 24V
- Power Per Module: 4pcs x1.8W=7.2W
- Adapter: DC 24V,3A,96W (Expansion Kit)
- 3.04800 meters lead-in to the first Smart LED Light
- 1.52400 meters cable between each Smart Light
- Lamp body material: ABS
- Color Temperature: RGBW
- Beam angle: 45-60 degrees
- IP Rating: IP65
- Working Temperature: -25°C- 40°C

How to use it?

02. Download and APP registration

Download the "Smart Life" APP from the APP Store (for iOS) and Google Play Store (for Android) and register with the phone number/email/Social Media account:



2

Step 1. Connect the light with your Smartphone Open the "Smart Life" app - press the "Add" device in the upper right corner-select "Lighting" "Device"-Select, then go to the Add device page.

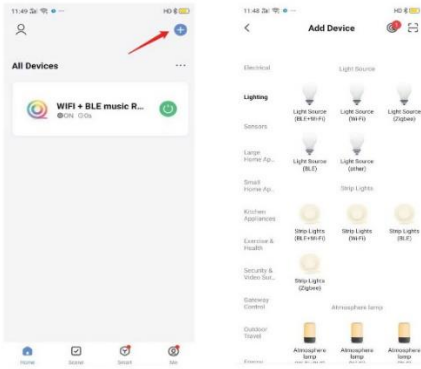

Step 2. Follow the instructions on the APP and let your device enter setup mode, if the light is blinking fast, skip the reset step
 Note: There are two ways to reset the light

- 1. Power on
- 2.. Turn On-off(3-5sec.)-on-off(3-5sec.)-on-off(3-5sec.)-on-off(3-5sec.)-on-off(3-5sec.)-on-off(3-5sec.)-(Repeat this step 5 times)
- ③ Ensure light is fast blinking)

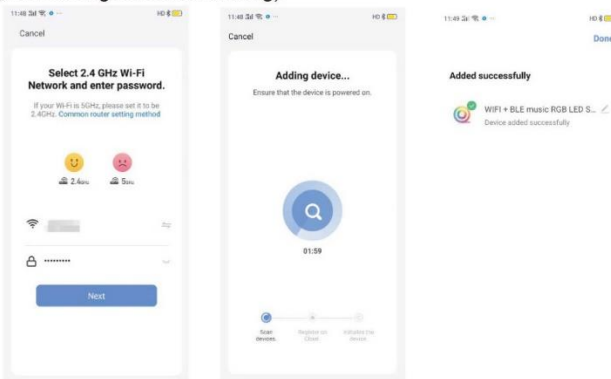

Step 3. Confirm that the light is flashing quickly-enter the Wi-Fi password to connect with the light, connection successful. Choose the light level, color, and scene you like.

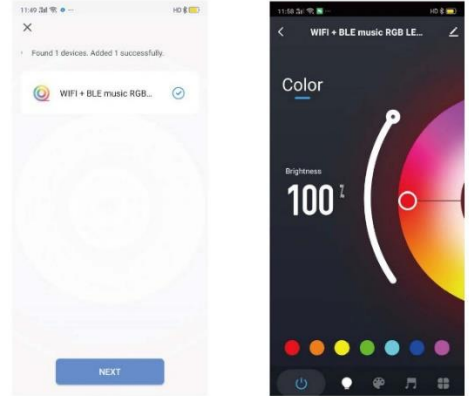

Step 4. You can set the " left time program on the left to turn off the light, and set the program on the right to set the opening and closing time of the Smart Rail Light, to enjoy your intelligent life.

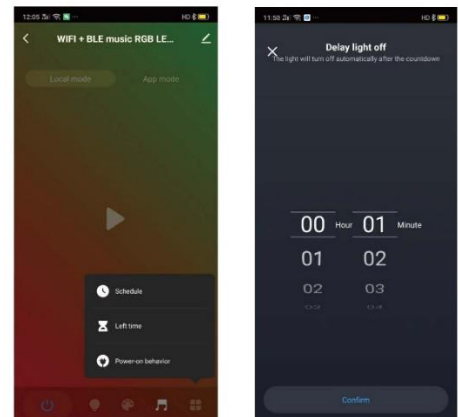

Step 5. Install the Smart Rail Light system controlled by Alexa / Google Home Click for more services---select featured---select third party access service--select " Amazon Alexa " or " Google Assistant " ---follow the instructions

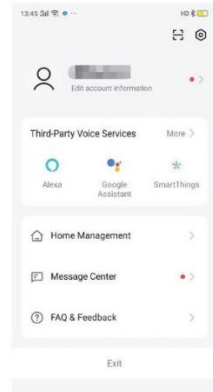

- FLASH RGB FLASH mode
- FAVORITE work mode switch
- 30min Count down 30 minutes and trun off the light
- MUSIC music mode switch



- Turn on and test the 2 Sets of Rail Lights from the GEM-ABGRSK "Gemini" Starter Kit and pick a color from the App.
- Center the LED Module on your desired location underneath the top rail and mark with a pencil. Remove the 3M protective paper from the back of the LED Module exposing the double-sided tape.
- Press the LED Module firmly on your desired location underneath the top rail (for permanent adhesion use a dab of liquid nail).
- Take any slack wire between the LED Modules and use the (3M wire clips and twist ties) to secure the wire together as needed.
- Use the (small 3M peel and stick clips) supplied in the plastic bag to secure any remaining slack wire.
- From the first Rail Light location, tuck any of the Flat Cable into the top of the vertical rail posts following the top rail and tuck the remaining Flat Cable down and behind the desired vertical rail to hide it completely.
- ****Please put the remaining Connector Caps on the exposed Connectors****

This warranty applies to products used in swimming pools, spas, & aquaculture applications only and does not apply to any product which has been subjected to negligence, alteration, accident, abuse, misuse, improper installation, abrasives, corrosion, improper voltage supply, vandalism, civil disturbances, or acts of God (including but not limited to damage caused by freezing, lightning strikes, and other damage caused by catastrophic events). The only warranties authorized by NeuTerra are those set forth herein. NeuTerra does not authorize other persons to extend any warranties with respect to its products, nor will NeuTerra assume liability for any unauthorized warranties made in connection with the sale of its products. NeuTerra will not be responsible for any statements that are made or published, written or oral, which are misleading or inconsistent with the facts as published in the literature or specifications furnished by NeuTerra.

Warranty Claim Procedure

Warranty claims shall be made by contacting the installer/seller, builder, dealer, or retailer (point of purchase) or the NeuTerra pool products distributor in your area. All equipment must be inspected by a local NeuTerra authorized representative or at the factory before warranty is authorized. All charges or expenses for freight to and from the factory, removal and reinstallation of the products, or installation of a replacement product are the responsibility of the purchaser unless otherwise expressly authorized in writing by NeuTerra. NeuTerra, at its discretion, may repair or replace free of charge (F.O.B. 3641 Old Conejo Rd. Newbury Park CA 91320) any product that proves defective within the warranty period, or it may issue credit in the amount of the invoice of the defective product in lieu of its repair or replacement. NeuTerra reserves its right to substitute new or improved product on any replacements.

Thank you for your purchase and “Bringing the Party Outside!”

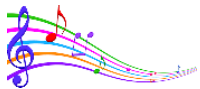

We hope you enjoy and tell your friends! For questions or additional product information, please visit our website at <http://www.neuterralighting.com/> or contact our Smart Lighting Team via info@neuterralighting.com



