

ScruboZoom™

Cordless Aboveground Robotic Pool Cleaner

Instruction Manual

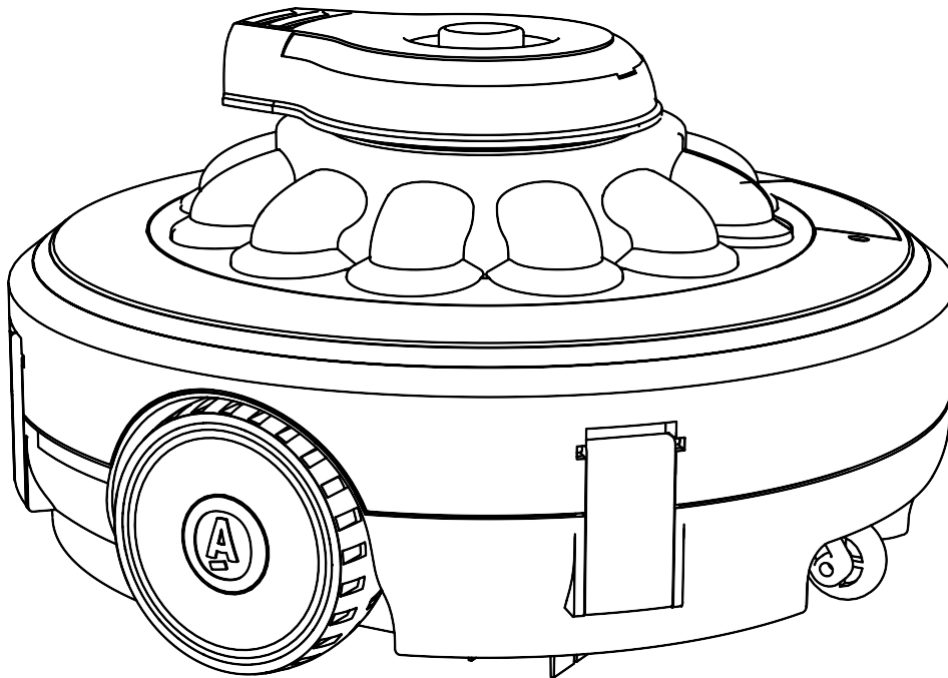

Battery: 7.4V /4000mAh

Charging power: 8.4V DC, 1.5A

Motor voltage: 7.4V DC

Waterproof grade: IPX8



SAFETY GUIDELINES

When installing and operating this cleaner, you should read the following basic safety precautions carefully.

Warning!

This cleaner is not a toy and should be operated by a person older than 8 years of age. It is highly recommended that anyone who operates this cleaner, read this manual carefully before using it.

- (1) The cleaner is designed to clean an above ground swimming pool.
- (2) Please use the original batteries and charger that accompany this cleaner.
- (3) Only charge the cleaner while in the off position.
- (4) Store the cleaner in a well ventilated, dry location. Avoid storing this cleaner in direct sunlight.
- (5) The filter bag may tear if sharp objects are found in the pool water.
- (6) The cleaner automatically shuts down when it is out of water.
- (7) Never block the suction ports while the cleaner is operating to avoid harm to the cleaner and to the object or person blocking the port(s).
- (8) Do not disassemble the cleaner without professional guidance from an authorized repair representative.
- (9) Shut off the power to the cleaner should something go wrong. Contact your supplier for further guidance.
- (10) Only use original ScruboZoom™ parts should a repair be needed.
- (11) Cleaner working conditions:
 - (11)-1 Maximum applicable water depth: 1,50m (5 Ft).
 - (11)-2 Water temperature: 4°C (39.2°F)-35°C (95°F)
- (12) **CAUTION ! Replace cap when in use or warranty may be void.**

CHARGER:

- (1) Only use the original charger provided.
- (2) For indoor use only. The charger should not be used outdoors and should not be exposed to rain, humidity moisture or heat.
- (3) Keep the charger out of reach of children.
- (4) Never use the charger if it is damaged.
- (5) Do not handle the charger with wet hands or bare feet when charging the cleaner.
- (6) Disconnect the charger from power when not in use.
- (7) If the charger wire is damaged, it must be replaced by a new charger to avoid any danger.
- (8) Make sure the cleaner charging port and charger are totally dry before charging.
- (9) Charge the cleaner 4-5 hours prior to the first use. This cleaner can be operated for approximately 60 minutes after it is fully charged.

The above safety guidelines are not intended to include all possible instances for risk and/or severe injury. Pool owners should always exercise caution and common sense when operating the cleaner.

Assembly

- A: Floater
- B: Upper cover
- B-1: Jet head
- C: Filter
- D: Bottom base
- E: Charger

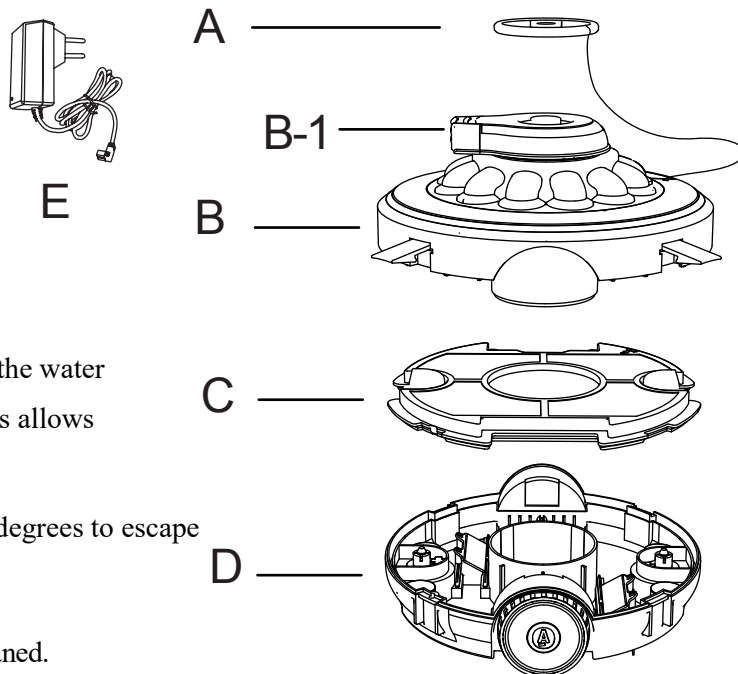

The jet head is located on the upper cover and rotates as the water flows from the bottom of the cleaner to the jet head. This allows the cleaner to move throughout the pool.

When an obstacle is encountered, the jet head turns 180 degrees to escape the obstacle by moving in a new direction. All debris is captured by the filter and stored in the bottom base until cleaned.

Charging warning

- Use only the original external adapter and the charging cable provided.
- Make sure the robot and charger ports are clean and dry before installation.
- Charge the robot for about 5 hours before using it for the first time.

1. Remove the pin cover from the charging port located on the bottom of the robot. To avoid losing the pin cover, connect it to the charging cable.
2. Connect the charger cable plug to the charger port located on the bottom of the cleaner, then plug in the charger adapter to a 110 v wall outlet.
3. After the robot is fully charged, remove the charger plug from the charger port located at the bottom of the cleaner and place the pin cover over the charging port on the robot. Make sure the pin cover is securely fastened prior to putting the robot in the water.

Note: Once the robot starts charging, the indicator light on the external adapter will turn red. When the robot is fully charged, the indicator light will turn green.

3. When fully charged, pull the charger out of the charging port at the bottom of the body, and put back the pin cover to the charging port. Make sure it is sealed before entering the water.

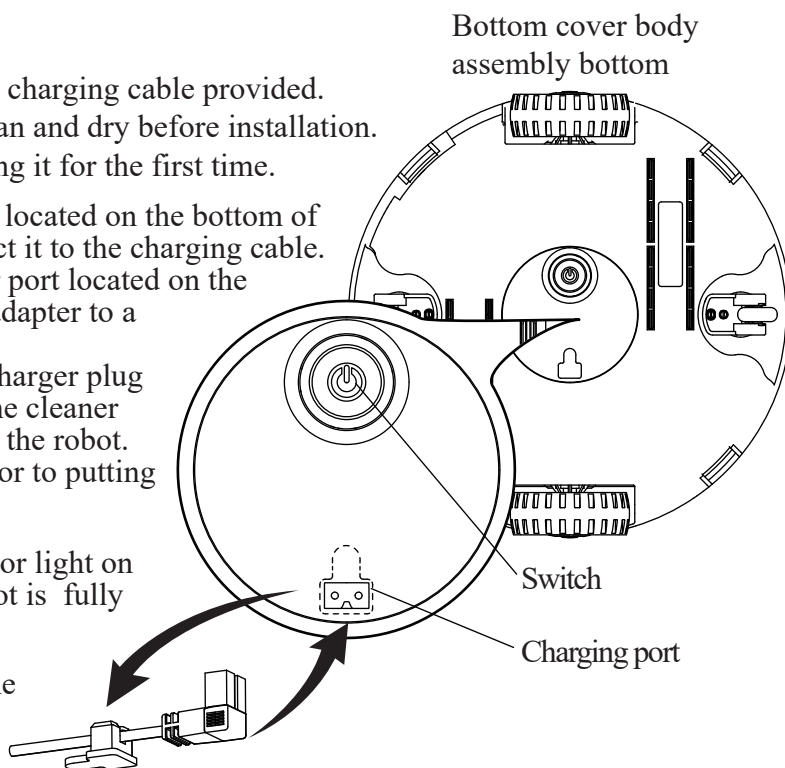

Power on

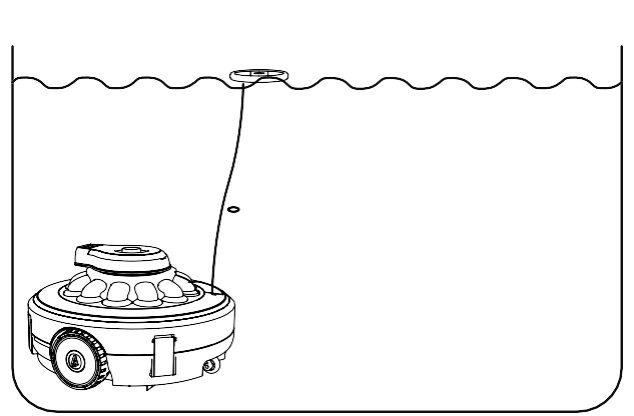
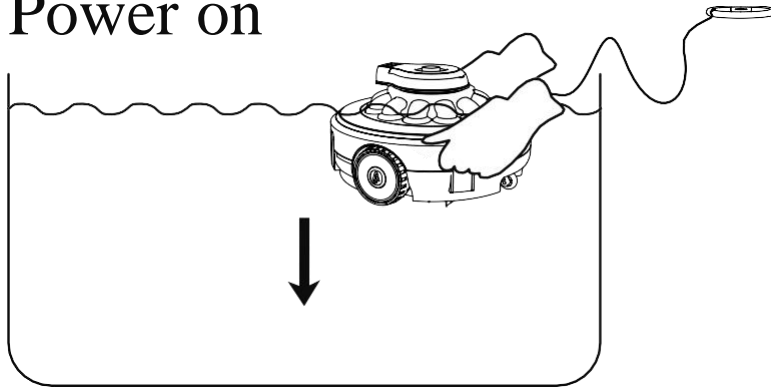

1. Place the cleaner under the surface of the water to allow water to fill it. Loosen the rope attached to the float, place the robot horizontally in the water, turn on the power and wait for the robot to sink freely to the bottom. (A safety feature will not allow the cleaner to operate out of water).

2. Adjust the length of the rope to ensure that the length of the rope is at the same height as the water level, and the extra length of the rope is tied or cut short.

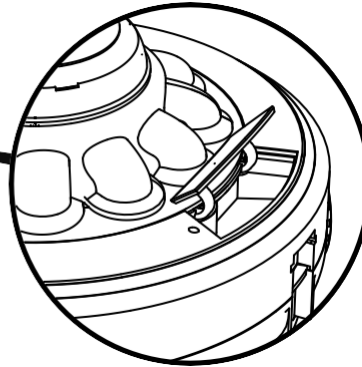
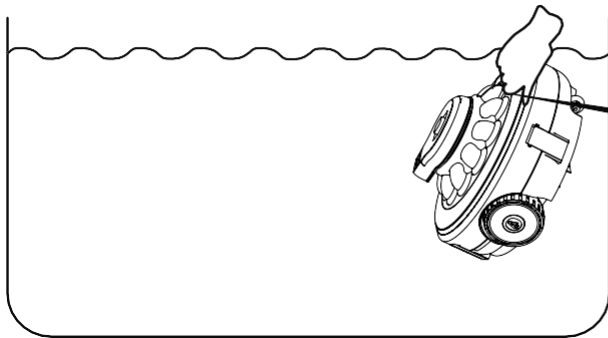

Open this plate to lift and carry the cleaner by hand.

3. When the robot has finished its cleaning cycle or the battery is depleted, it will automatically turn off.

Note: 1. It is recommended that the filtration system be turned off to prevent the pump's water flow from disrupting the cleaning pattern of the robot.

2. Any obstacle such as a ladder in the pool, may affect the robot's cleaning path.

Debris Removal and Cleaning

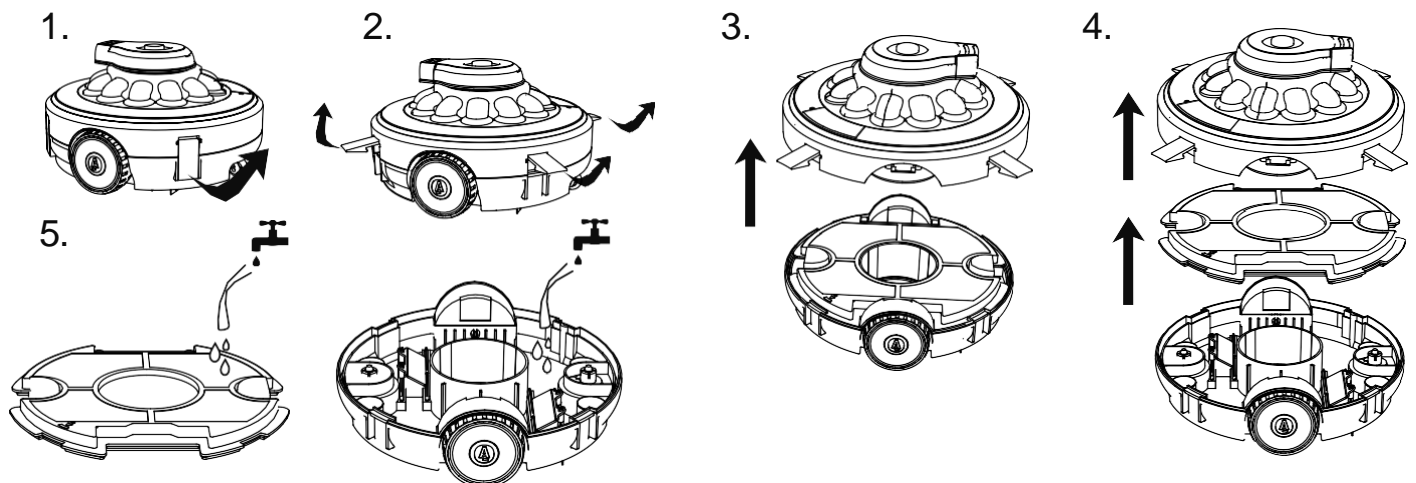

Maintenance and Storage:

1. The battery will discharge during storage. Make sure the cleaner is fully charged before storage.
2. When not in use, you must charge the battery at least every three months.

Maintenance:

- Unplug the charger from the electrical outlet and the charging cable from the cleaner.
- Clean and dry the robot and accessories thoroughly using water and a clean cloth. Do not use detergent.
- Remove all water from the cleaner prior to storing it.
- Store in a dry, well-ventilated place away from direct sunlight, heat, fire sources, pool chemicals and children.
- The storage environment temperature should be between 50° F - 110° F.

Note: higher storage temperatures may shorten battery life.

Maintenance and replacement of impeller

Recommended tool (not included): screwdriver

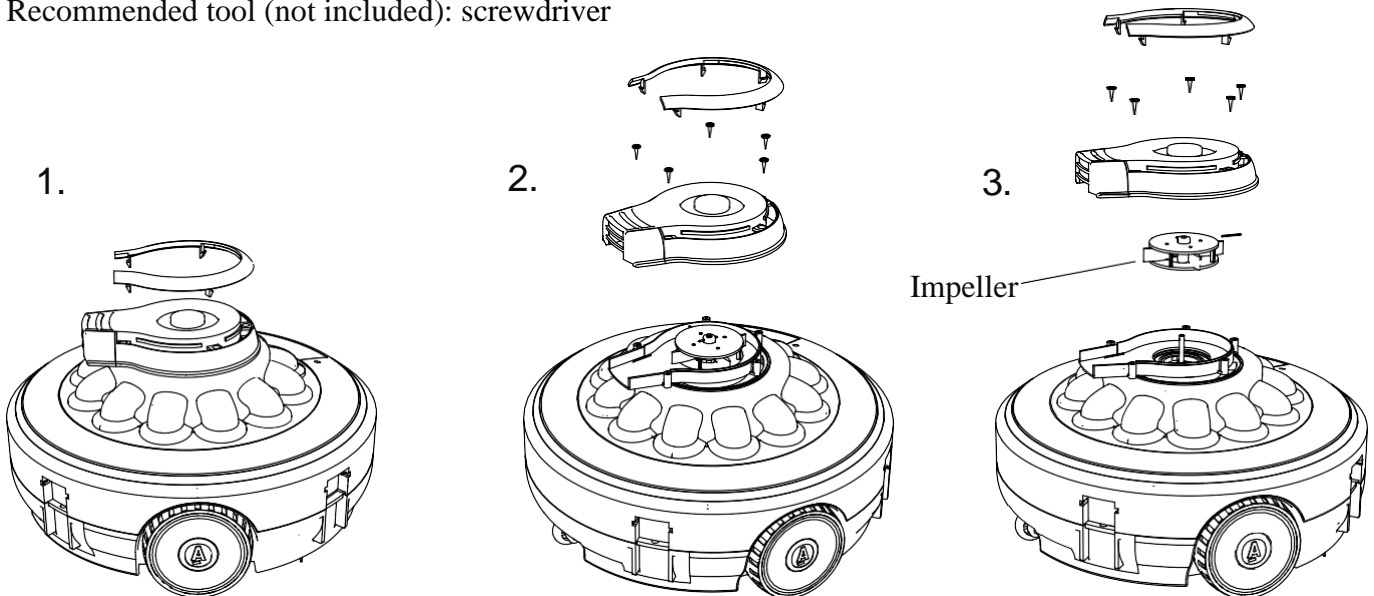

Maintenance and replacement of wheels

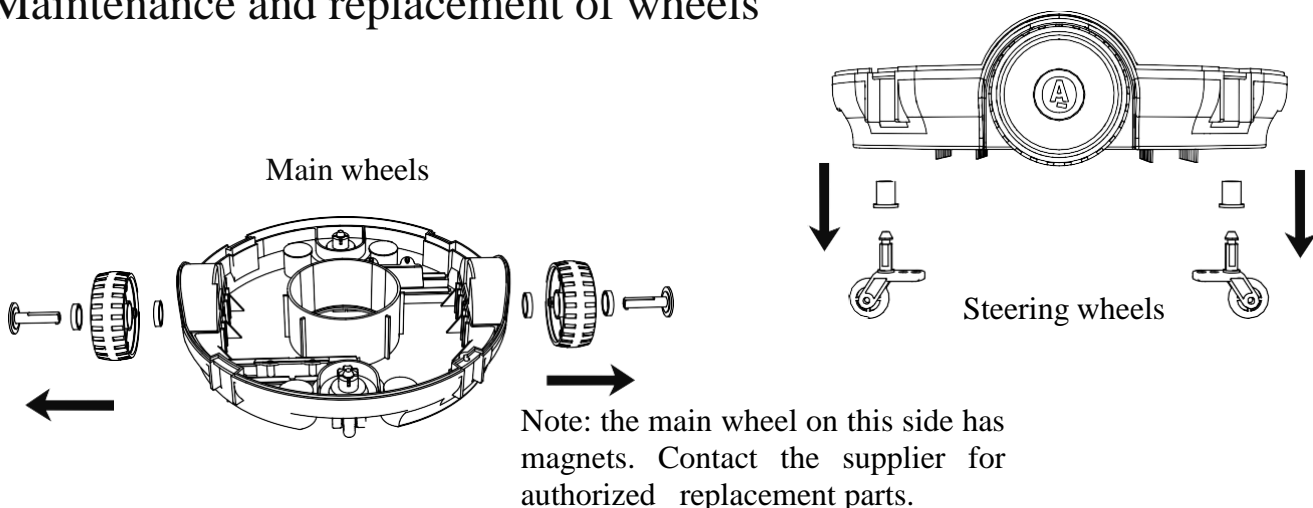

Support and Service

For support and service of your cleaner, please call: +1 888-346-1327

OR

Got to www.aquamoto.com

Warning!

Battery Warning

DO NOT attempt to remove the battery. **The battery installed in the unit is not user serviceable.** For replacement or disposal, please contact Aquamoto customer support or go to: www.aquamoto.com/recycle for more information.

(1) The cleaner battery is a lithium battery, it must be disposed properly, please contact with your local authority for more information.

(2) **Never attempt to disassemble the lithium battery.**

(3) **Keep the cleaner away from flames and other sources of intense heat.**

(4) If the battery leaks, do not allow the leaking fluid to come into contact with eyes, skin, or clothing. If the fluid is already in contact with the eyes, do not rub them. Rinse the eyes with clean water immediately and seek medical advice.

The above warnings and cautions are not intended to incorporate all possible instances for risks and/or severe injury. Pool/spa owners should always exercise intensive caution and common sense when operating the cleaner.

Trouble shooting

If you have problems with your cleaner, follow the troubleshooting steps below to restore performance.
Note: Turn off the power before making any repairs.

Problem	Possible causes	Solution
Robots does not capture debris.	The battery is low.	Then charge the robot.
	Impeller is stuck.	Turn off the power to the cleaner and visually check whether the impeller rotates. If necessary, contact your supplier for further instructions. Warning! Before servicing the cleaner, make sure that it is turned OFF.
	Impeller is damaged.	Please contact your supplier for replacement.
	The debris compartment is full.	Empty and clean the compartment and clean the filter screen.
The robot stops moving in the middle of the pool (the rotating head is still turning).	The cleaner is stuck on an obstacle.	Check the cleaner for obstructions. Remove all obstacles.
	The cleaner is stuck on the main drain.	Turn off the filtration system (see instructions in the manual).
	The pool floor is not totally flat	The cleaner hesitates before moving and takes a longer period to clean the pool because the floor is not flat. Contact your supplier for further guidance.
The robot cannot cover the entire pool or moves along the pool's wall.	The debris compartment is full.	Empty and clean the compartment and clean the filter screen.
	The operation time was shorter than expected.	Clean the filter chamber and recharge the robot for 4-5 hours
	The water circulation generated by the filtration system interrupts the direction of movement.	Turn off the filtration system (see instructions in the manual).
	The wheel is stuck.	Check and remove debris from the wheels.
The robot moves slowly.	The glove box is full.	Clean the glove box and filter cover.
The turning head does not rotate or rotates slowly.	The bottom of the swivel is stuck.	The debris compartment is full, check and remove any debris that may be stuck under the rotating head. It can be rotated by hand and rinsed with water until smooth.

The debris escapes from the robot.	The suction valve nozzle (bottom of the cleaner) is broken.	The baffle at the suction entry acts like a door to prevent debris from escaping from the debris chamber. Contact your supplier for replacement parts and instructions.
Debris enters the outside of the filter cover.	The filter cover is damaged.	Replace the filter cover with a new one. Please contact your supplier for replacement parts.
The robot cannot charge.	Battery is damaged.	Please contact your supplier to replace the battery. Warning! DO NOT turn on the robot and replace the battery yourself. This can cause serious or fatal injury and the warranty will be VOID.
	The charging cable is not fully connected to the external adapter of the robot.	Make sure the charger cable is properly connected to the external outlet and to the robot. Please refer to the user manual.
	The external adapter is broken.	Contact your supplier for replacement. Warning! Using the wrong external adapter will result in damage to the robot and battery which will void the warranty.
The robot can still work without water.	The water of the robot is not dry, and the contact is short circuited, so the robot can still work without water.	Leave it outside the water for a few seconds and wait for the water to dry
	There is debris at the contact point, such as wet hair, which causes a short circuit at the point of contact.	Remove hair and other debris with tools
	Circuit board is damaged	Please contact your supplier for replacement.