

# HYDRA

P O O L S

## STRUCTURAL POLYMER WALL SYSTEMS STEEL WALL SYSTEMS

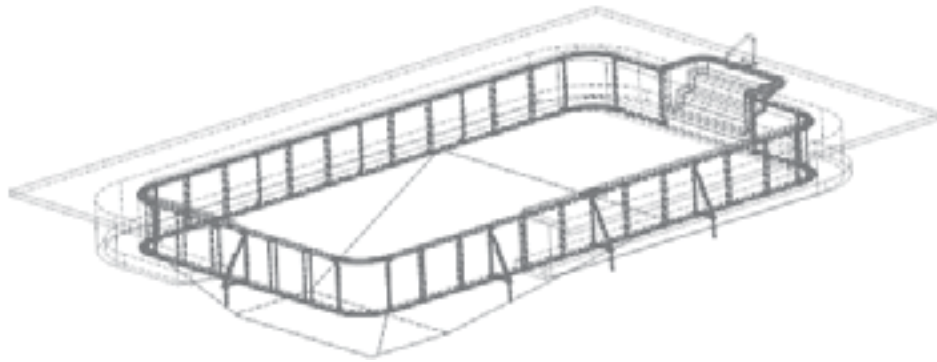
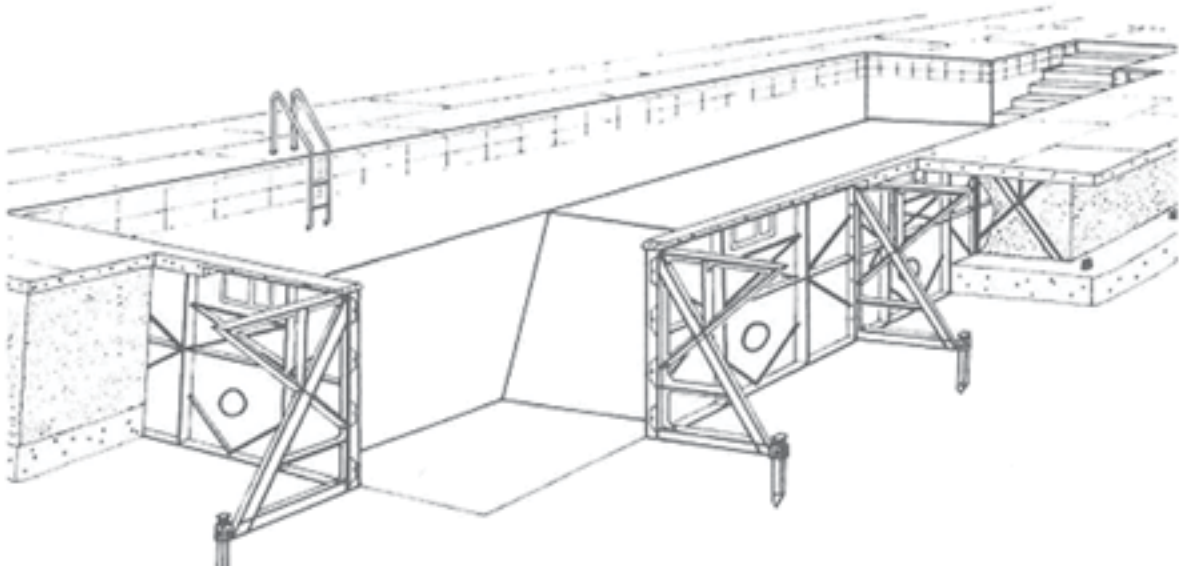

HYDRA

CORNERSTONE

PINNACLE

SAMSON STEEL

INSTALLATION MANUAL

INSTRUCTIONS FOR POOL LOCATION • EXCAVATING • GRADING • WALL AND LINER  
INSTALLATION • BACK-FILLING • DECKS • LIGHTING • STEPS • PLUMBING AND DRAIN

For A Copy of

## **Standards for Residential Swimming Pools**

Contact the:  
APSP  
2111 Eisenhower Ave.  
Alexandria, VA 22314  
(703) 838-0083  
(703) 549-0493

## **Contents**

General Guidelines	3
Pool Location/Layout	4
Excavation	6
Panel Installation	8
Step Installation	10
Coping Installation	11
Plumbing	12
Collar	13
Bottom	14
Liner Installation	16
Deck	19
Detail Drawings	20
FAQ's	23

## **IMPORTANT NOTICE**

The owner's manual accompanying your Hydra Pool kit contains detailed information regarding the correct installation and assembly of your pool. The incorrect installation and assembly of your pool, including but not limited to incorrect excavation and site preparation, will impair the life span of your pool, cause your pool to leak, and also void your Hydra Pool warranty. Installation of a swimming pool may require you to obtain advanced permitting and/or approval of local government agencies as well as compliance with applicable regulations, if any, such as perimeter fencing for your property.

## GENERAL GUIDELINES

Before you begin, check the pool component list and read the entire installation manual. During the various steps of installation, refer to this installation manual, the installation video and the appropriate “dig spec” drawing supplied to you. As always check any state or local buildings codes before proceeding

### Construction Sequence

1. Check with utility company in regards to underground utilities (gas, electric, phone, etc.)  
In many states there is a toll free number you must call prior to digging.
2. Obtain all necessary permits
3. Hire an electrician if needed
4. Arrange for water to be delivered if necessary
5. Arrange for fencing around the pool area and check local codes for requirements
6. Follow this installation manual carefully and complete only the steps that pertain to the Hydra polymer pool you are installing. REMEMBER, Hydra has three polymer pool lines and one steel pool line.

### Tools Needed for Installation

Adjustable wrench  
Screwdrivers  
Socket set  
25' and 100' tape measure  
Utility knife  
Extension chords  
String line  
Drills and assorted bits  
Shovels (flat and round)  
Trowel (Pool trowel 14")  
Carpenter's square and level  
Wheelbarrow  
3" hole saw  
Hacksaw  
2" hole saw

Large channel-lock pliers  
Broom  
Tamper  
Sledge hammer/regular hammer  
Hose  
Duct tape  
Transit (laser level preferred) (rent)  
Rakes  
MightyVac or commercial shop vac  
Pick axe  
Caulk gun  
Cement mixer/plaster mixer (needed for installation of vermiculite bottom—rent if necessary)  
Marking spray paint (for marking ground)  
Leather Gloves

### Heavy Equipment Needed (hire if necessary)

Backhoe or Mini-Excavator  
Bobcat  
Dump truck

Note: A qualified operator is needed for heavy equipment.

## POOL LOCATION/LAYOUT

Choose your pool's location very carefully, as a less desirable site can increase your time, cost and effort during installation. Consider the following when selecting a pool site:

1. Insure the pool is clear of all property lines and variances.
2. Insure a minimum 10' wide opening for access to the pool site by large equipment and concrete trucks.
3. Insure the pool site is clear of all underground pipes, tanks, wires and overhead wires.
4. Level ground is preferred but not required. Water drainage away from all sides of the pool is necessary.
5. The pool site should be in a sunny area with few, if any, trees around the pool.
6. Try to position the long wall with the skimmer facing the prevailing winds.
7. Building on backfill areas is never recommended.

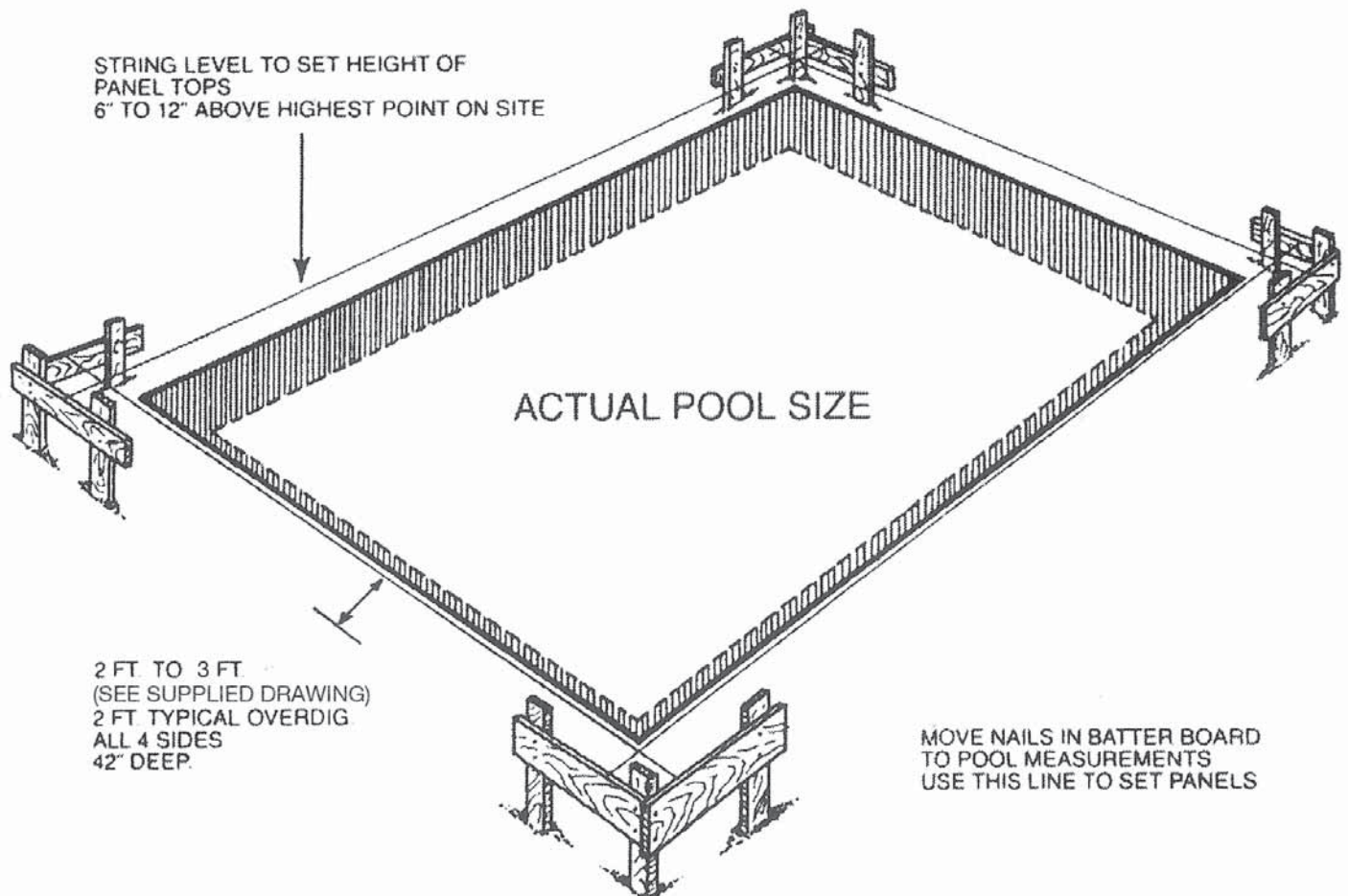

## INITIAL LAYOUT

### Rectangle

All rectangle pools have a two foot to three foot over-dig (depending on panel line and the brace combination) to form a shelf for the panels. Start by driving four stakes in the ground to make a box two feet to three feet larger than the pool you are installing. For example: A 20' x 40' pool requires a box that measures 24' x 44' or 26' x 46'. Square the box by measuring diagonally from stake to stake, ensuring all measurements are the same. (See figure 1)

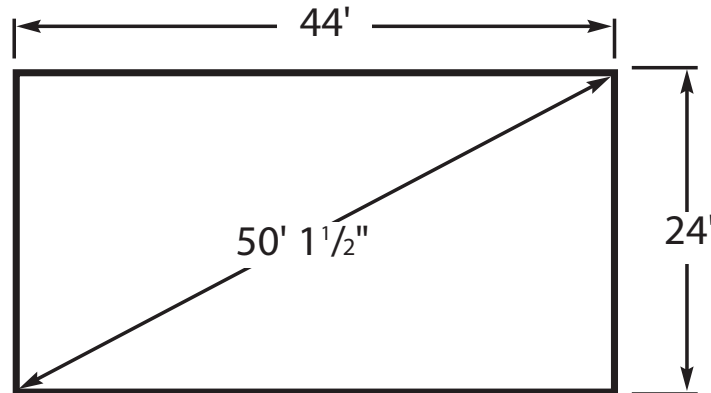

Figure 1: Rectangle Pool Layout

### Oval

All oval pools have a two foot to three foot over-dig (depending on the panel line and brace combination) to form a shelf for the panels. Start by driving four stakes in the ground to make a box that is four feet wider than the pool, but that measures the same in length. For example: A 18' x 36' pool requires a box that measures 22' x 18'. Square the box by measuring diagonally from stake to stake, ensuring all measurements are the same. To create the radius ends of the pool, locate the center point of the 22' width and drive a stake. Holding the end of a tape measure on the stake, move out 11' and paint an arc, connecting the ends of each straight side. (See figure 2)

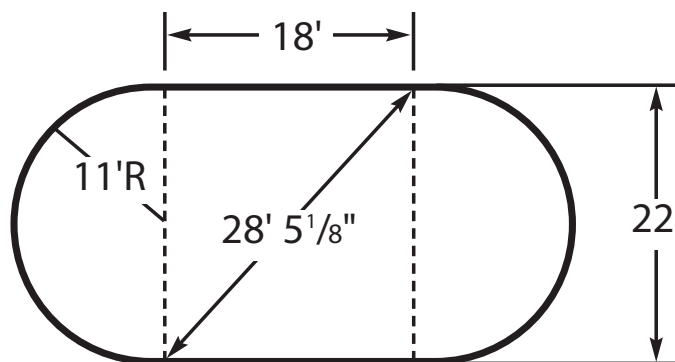

Figure 2: Oval Pool Layout

### Octagon

All octagon pools have a two foot or three foot over-dig (depending on the panel line and brace combination) to form a shelf for the panels. Start by driving a stake at the center point of the pool. Holding the end of a tape measure on the stake, move out one-half the width of the pool, plus two feet for the over-dig, and paint a circle around the center stake. For example, a 24' octagon would require a circle 14' from the center stake.

## SETTING POOL ELEVATION

The top of the panel should be no less than 8" above the existing grade. Twelve inches is suggested to keep all drainage away from the pool (see Figure 3). Now stretch a string line to each of your layout stakes at the level of the top of the pool (see Figure 4). If using a laser level, set the proper benchmark.

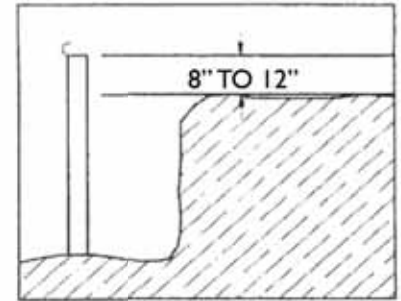

Figure 3: Pool Elevation

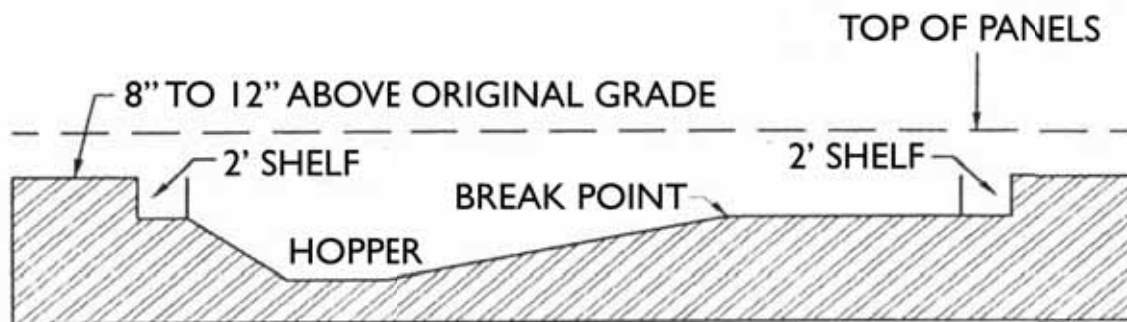

Figure 4: String Level / Pool Layout

## EXCAVATION

All dimensions in the Pool Layout and Dig-Spec are grades, **not** finish grades, **so your excavation should always be 2" deeper than your Pool Layout and Dig-Dimension drawing.** This allows space inside the pool walls for the pool base (Portland cement/Sand mix, Poolkrete, etc.).

### Panel Shelf

Panels and braces will be assembled, set and leveled on the panel shelf. The panel shelf width will be determined by the panel line and brace that you are installing. **THE SHELF IS DUG 42" DOWN FROM THE STRING LINE OR FROM YOUR BENCHMARK.** This should be undisturbed earth, so use caution when digging the shelf. **DO NOT OVER DIG!!!** This is also the finish depth of the shallow end.



## Shallow End

Excavate the shallow end to 42" below the benchmark. If steps are to be installed, dig 2' to 3' wider than the step shelf (see Figure 5).

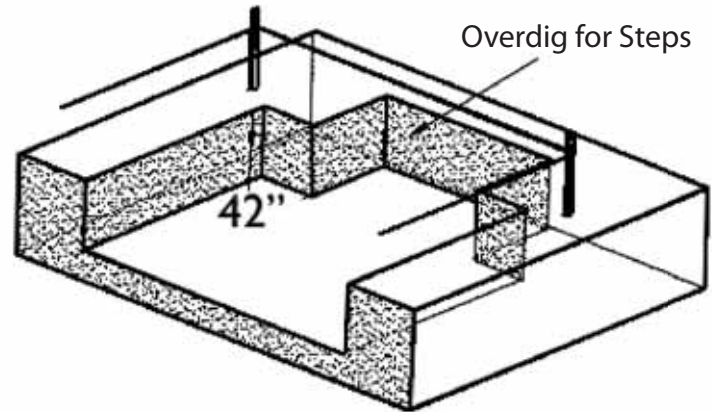

Figure 5: Shallow End

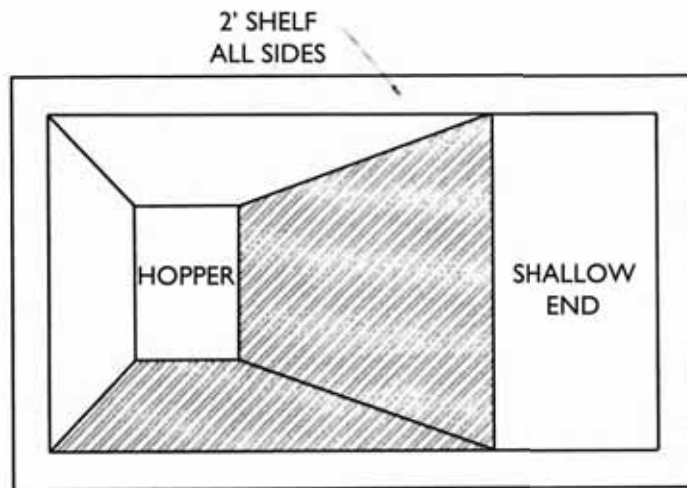

Figure 6: Shallow End

## Deep End

Once the shallow end is dug, paint a line across the pool to represent the break point. To understand the shape of the deep end on a standard hopper pool, envision the hopper as an upside-down pyramid, whose top has been cut off (see Figure 6). To achieve this shape, start by dividing the length of the pool into 10 equal sections. Mark the first section as the 'hopper' and the remaining 9 sections as the 'deep end'. Then, dig the deep end to the required depth.

into 10 equal sections. F  
hopper for the first section. As  
sid . F  
w  
should  
same  
sid . F  
p ly. DO NOT DIG !

N  
'deepe. The  
. N conti  
ly, and monitor the digging

## GROUND-WATER CONDITIONS

Ground water is the term used for the water table. If you should encounter ground water while digging the hopper, don't panic. Just follow these simple recommendations:

1. Over dig just the bottom of the hopper by 1' to 2'.
2. Use pea-sized rock to bring the hopper back to grade.
3. Set a foot valve, available at a plumbing supply store, in the pea stone and plumb it to outside of the pool.
4. Run a plumbing line from the hopper to near the filter (see Figure 7).
5. Hook the foot valve to a pump and keep the pump running continuously until the liner has been dropped and the pool is full of water.
6. When installation is complete cap the plumbing line, leaving it available for use in the future, should the liner need to be replaced.

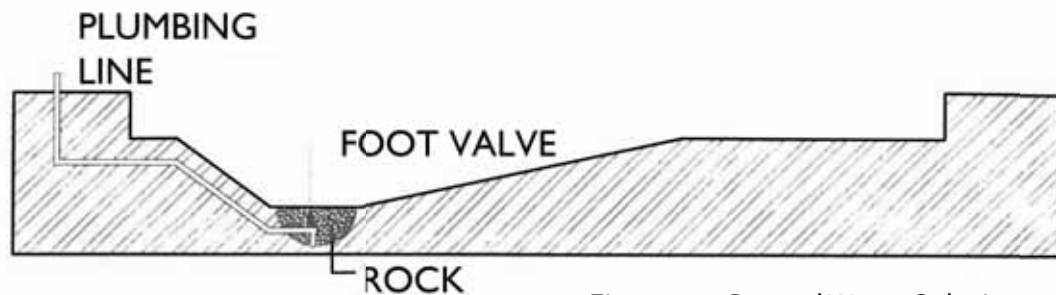

Figure 7: Ground W. Solution

## PANEL INSTALLATION

Note: For safety, wear gloves when handling steel panels and components.

Start by laying out all panels on the panel shelf. Position a brace and necessary bolts (depending on the brand of panel) at every panel joint, as indicated in the Pool Layout and Dig Dimension Drawing supplied to you.

Starting in the appropriate place for the shape of the pool being built (see pg. 9), fasten panels and braces together using the supplied bolts. Align the panel joints for a tight fit and hand-tighten (snug) the supplied non-corrosive bolts. **DO NOT OVERTIGHTEN!!**

Panels are available with pre-cut holes for most commonly used skimmers. Position the skimmer panel according to the following guidelines:

1. The skimmer should always be placed on the long wall of the pool, with the prevailing winds blowing into the skimmer.
2. If you are building a hopper pool, locate the skimmer as per supplied drawing.
3. Insure the skimmer panel will be clear of the wall-mounted safety-rope anchors.
4. Locate returns on walls opposite the skimmer, to push surface debris towards the skimmer.
5. Aqua Genies do not require additional returns, see the Aqua Genie Manual.



## Starting Point – Rectangular Pools

Begin in a shallow-end corner. In 4' radius pools, start by bolting the two corner panels together, with a brace offset from panel joint. Then connect the corner panel assembly to an end-wall straight panel, with a brace offset from flanges (see figure 8). Continue to assemble panels and braces according to the Pool Layout and Dig Dimension Drawing. If steps are present, determine their location before starting panel assembly and complete the step installation process (pg. 10) when you reach their position.

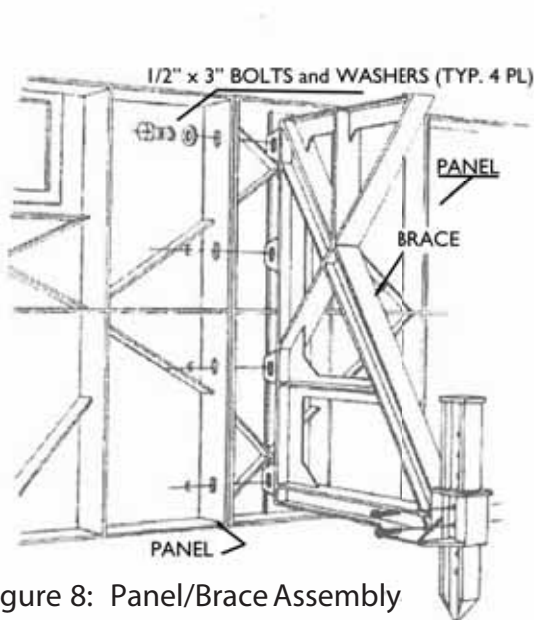
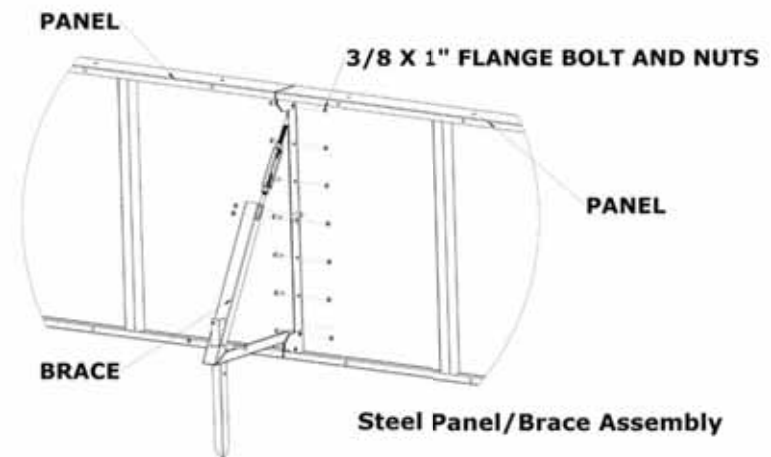

Figure 8: Panel/Brace Assembly  
Polymer



## Starting Point – Oval Pools

Begin at a straight side wall and bolt the straight panels and braces together. Repeat this process for the other straight sidewall. Square both sidewalls by measuring diagonally across the pool at both the top and the bottom of the panels. Drive stakes a few inches into the ground at the ends of the straight sections to hold them in place. Begin to assemble the radius ends. Bolt the curved panels and braces to the end of a straight sidewall. If required, use 5° wedges (see Figure 9) to adjust the radius, as indicated in the Pool Layout and Dig Dimension Drawing. Continue to assemble panels and braces according to the Pool Layout and Dig Dimension Drawing. If steps are present, determine their location before starting panel assembly and complete the step-installation process (pg. 10) when you reach their position. Insure the radius is true by driving a stake halfway between the sidewalls, stretching a tape measure from the stake to the radius panels, and checking the distance at various points on the curve. All measurements should be the same. If not, slightly shift the curved panels until a constant radius is achieved.

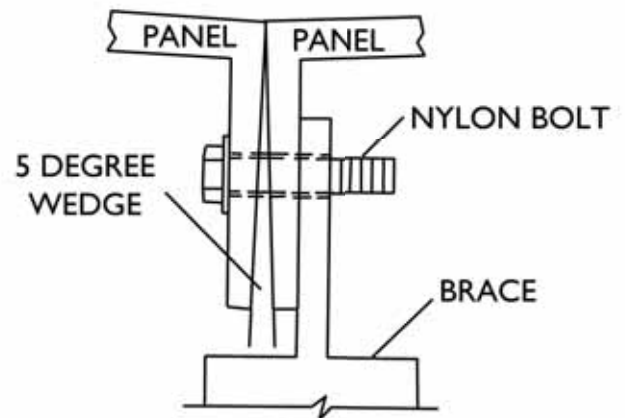
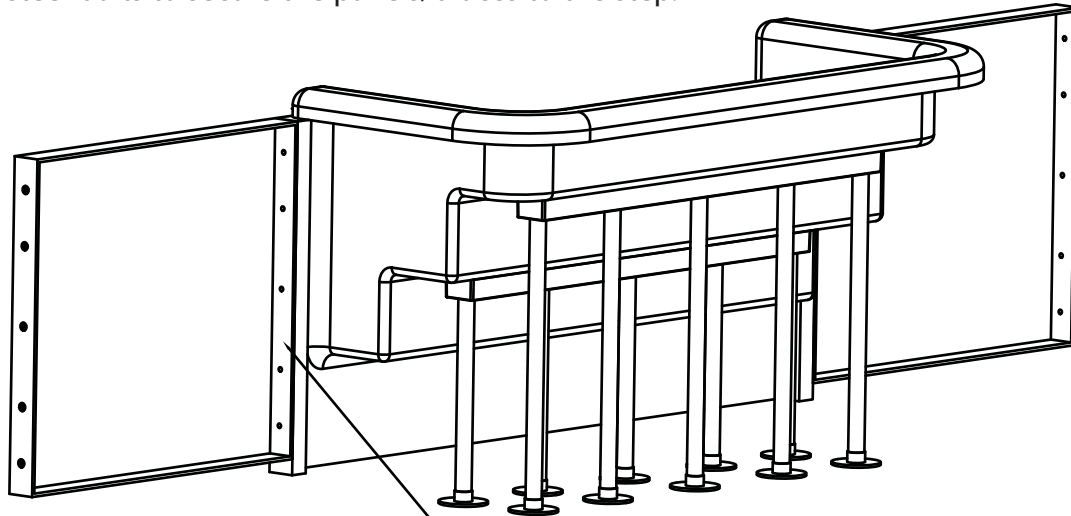

Figure 9: 5° Wedge Installation

## SWEETWATER STEP AND SWIM OUT INSTALLATION

Steps and swim outs are installed in the same manner. Start by setting the step in the excavated area according to the Pool Layout and Dig Dimension Drawing. Use supplied step support system. With the step in place, clamp the neighboring pool panel to the step, insuring that the face of the step is flush with the panel and that the top of the panel is flush with the bottom of the step coping-receptor nose.

With the panel and step clamped tightly together, drill 3/8" holes through the panel holes into the step flange. Use stainless-steel bolts to secure the panels/braces to the step.



Clamp panel to step tightly and drill with 3/8" bit and use stainless steel bolts

## INSTALLING ALUMINUM COPING

Two types of coping are provided with your Hydra pool system: straight and pre-shaped. Start by installing all pre-shaped coping. This includes 6", 2', 4' and 9' radius, Roman End, 45 degree, Lazy-Ell and True-Ell coping. Start by positioning the pre-shaped coping on the appropriate panels, insuring that the coping lip fits snugly against the face of the panel. Using the self-tapping screws provided, secure the pre-shaped coping to the panels, starting at the ends of each piece of coping and continuing every 12" along the length of the coping. Next, install the straight coping to the panels using the self-tapping screws provided. When installing the straight coping, insure that the coping joints do not line up with any of the panel joints, except at the junction of the straight and pre-shaped coping. Finally, snap the coping clips over all coping joints.

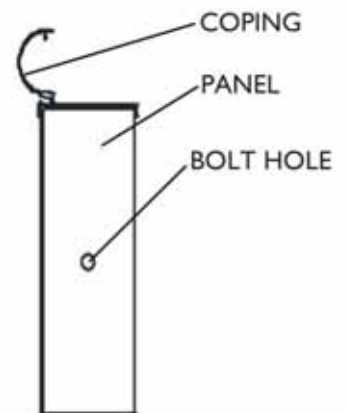

Figure 10: Coping Installation

## STAKE AND SECURE THE POOL

At this point the panels are ready to be secured to the ground. First, use a hacksaw or sawzall to detach the polymer stakes from the braces. Place the stakes in the channels at the back of the braces and drive them into the ground, using a sledgehammer. SAFETY GLASSES MUST BE WORN WHEN DRIVING STAKES! Leave 1" to 2" of stake visible above the top of the stake channel. Snap the locking pin off the brace and use it to secure the brace to the stake (Note: Steel stakes are also available). Next, drive 3/8" rebar through the pre-drilled holes in the bottom of each panel. this keeps the bottom of the panels from shifting when pouring the concrete collar. Use 18" pieces of rebar, driven 12" into the ground. Finally, brace the step. Use 3/8" rebar and a 2" x 6" wooden plank, as shown in figure 11.

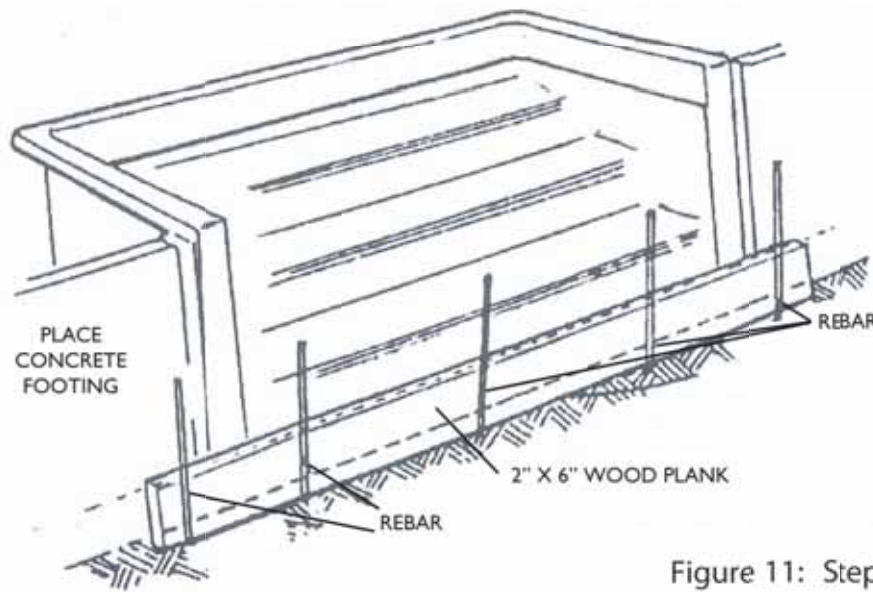

Figure 11: Step Bracing

## FINAL CHECK - ALL POOLS

Once all panels, braces and steps have been bolted together and the coping has been secured to the panels, it is time for one final check. A few extra minutes spent verifying the shape of the pool at this stage of completion will lead to a proper liner fit and, ultimately, a job well done.

1. Check diagonal measurements across the pool, at both the top and bottom of the panels, and verify that they are the same.
2. Level all panels, using patio block or bricks at the panel joints, so that the top of the panel is level with the benchmark set at the start of construction.
3. Check all panels for vertical alignment using a carpenter's level on the face of the panel.
4. Check all straight walls for horizontal alignment. To do this, stretch a string the entire length for each straight wall, at the top of the panels, insuring that each panel lines up with the string.

## MAIN DRAINS

**(must be done before bond beam is installed) (two main drains must be installed or no main drains) its the law**

CHECK WITH YOUR LOCAL BUILDING/ZONING OFFICE FOR APPLICABLE CODES.

Dig two holes at least 3' apart in the hopper, 1' in diameter and 18" deep. Partially fill the holes with approximately 14" of rock. When the main drains are correctly positioned in each hole, the top of the drains should be at the finish grade, and there should be 4" to 6" of each drain exposed above the rock. The remainder of the hole must be filled with concrete to secure the drains in place. THE MAIN DRAIN MUST BE SET IN CONCRETE. To install your plumbing line, dig a small trench in the hopper, starting at the main drain, crossing the hopper, up the side or back wall slope (whichever is closest to the filter), and out under a panel. Set your line, cover with dirt and tamp. Leave the main drain faceplate and gaskets off until the liner is installed.

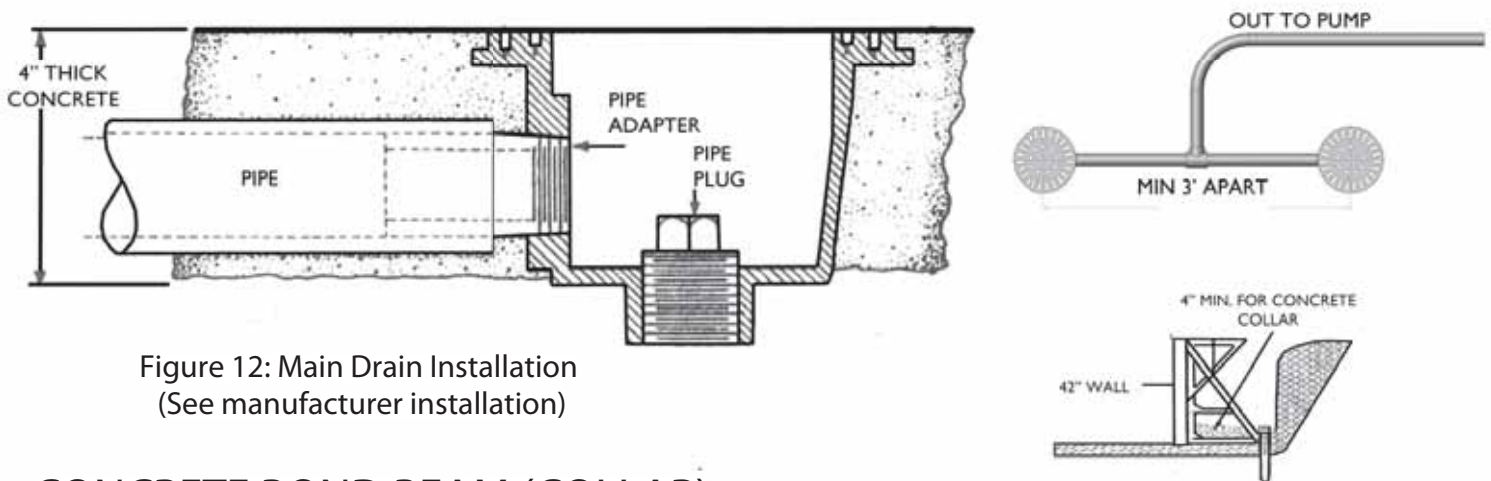

Figure 12: Main Drain Installation  
(See manufacturer installation)

## CONCRETE BOND BEAM (COLLAR)

When the main drain plumbing line is run, you are ready to pour the concrete collar around the pool. Make sure there are no gaps under the panels or step. If there are, tamp dirt to fill the opening. Now stretch a string line down the length of each straight wall at the back edge of the coping and insure all panels are flush with the string. Next, begin pouring your concrete collar. The concrete should be poured 8" to 12" thick. CHECK WITH YOUR LOCAL BUILDING/ZONING OFFICE FOR APPLICABLE CODES. Pour concrete SLOWLY to prevent forcing the walls out of alignment. After the concrete is poured, recheck all panels for proper panel alignment, using a string. When pouring concrete under the step, insure that the concrete touches the underside of the first tread for proper support. You may need to build a form to insure there is enough concrete to support the bottom step.

## SONO Tubes

Grasp the deck supports and break the rings free from the center of the brace. Push the rings into the sockets until they lock into place then place a 6" tube (cardboard or DWV pipe) into the supports and cut to proper length. Pour the tubes full of concrete when you pour the collar. This will provide a vertical column to support the deck.

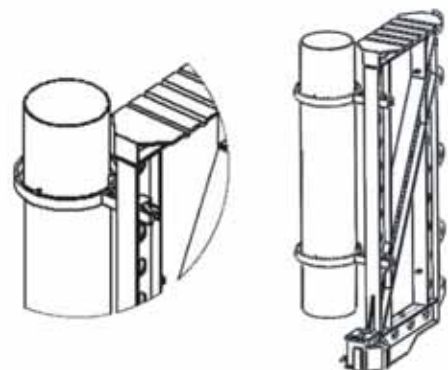

## SKIMMER

The skimmer panel is pre-cut for your convenience. Simply slip your skimmer through the cutout (See figure 13), install the shim kit (if a shim kit is needed) and fasten the skimmer to the wall panel following the manufacturer's instructions. Using this method of installation, gaskets are NOT required until liner installation. DO NOT CUT THE LINER UNTIL WATER IS AT LEAST 12" DEEP IN THE SHALLOW END OF THE POOL. For Aqua Genie installation, see the Aqua Genie manual.

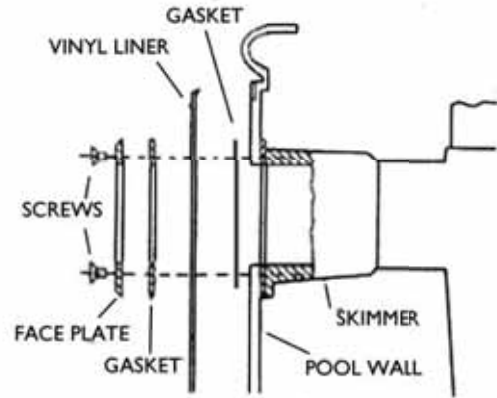

Figure 13: Skimmer Installation

## PLUMBING

Return fittings can be located on any wall, as long as they produce a circular flow pattern (counter-clockwise direction) on the surface of the water, toward the skimmer. Drill a 3" hole in the panel, 12" to 14" down from the top of the panel (NOT to the top of the coping). Drill from the back to eliminate hitting the cross bracing on the panels. Slide the return fitting through the hole inside the pool and install the locknut. Tighten snugly. Leave the fitting faceplate off until the liner has been installed and the water is at least 12" deep in the shallow end of the pool. The Aqua Genie has built in returns, any wall returns are optional.

Note: Step returns are different than wall returns. Wall returns have screws in the faceplate to attach to the wall, step returns have no screw holes.

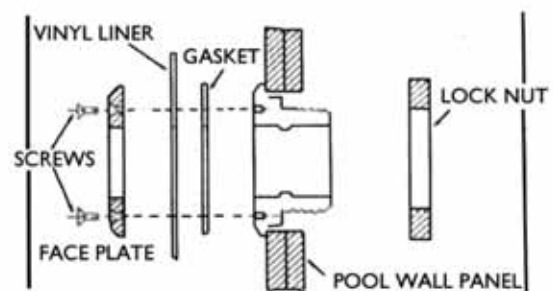
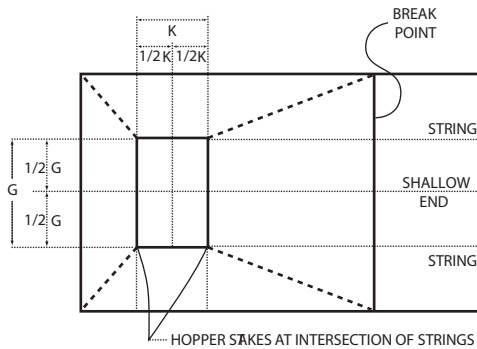

Figure 14: Return Installation



## GRADING THE POOL BOTTOM FOR SAND AND CEMENT

The pool must be graded 2" below the finish dimensions in the Panel Layout and Dig Dimension Drawing. This will be finished with a 2" layer of MASON sand and cement (in a 5-to-1 ratio) or a suitable pool base material (pool krete, etc.).



Locate the sides of the hopper pad by stretching parallel strings from the break point to the end wall. At the same time, locate the front and back of the hopper pad by stretching strings between the sidewalls of the pool.

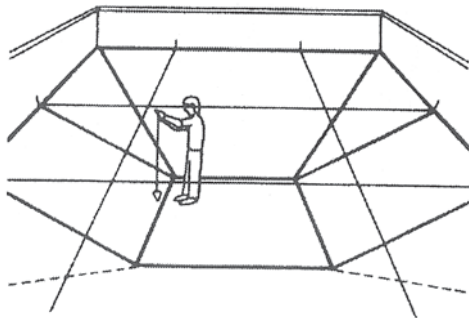

Find the finish grade by dropping a plumb bob at the intersection of the strings to the depth shown on your Dig Dimension Drawing. Drive a stake into each corner of the hopper beneath the plumb line and string a level line between stakes at the required depth to indicate the exact position and finish grade of the hopper.

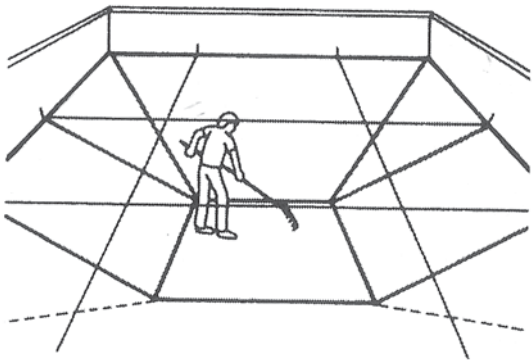

Once you have located the hopper pad, use stakes and strings in the same manner to mark the finish grade of the hopper walls, as shown on your Dig Dimension Drawing.

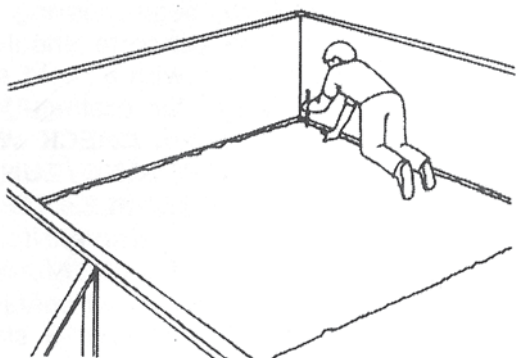

In each corner of the shallow end, measure the required depth from the top of the panels to the pool bottom and place a marker. String a level line between markers to indicate the finish grade of the bottom.



When the finish grade has been established, remove at least 2" of earth from below the strings. Tamp the entire area thoroughly and take away all stones, twigs and rocks.

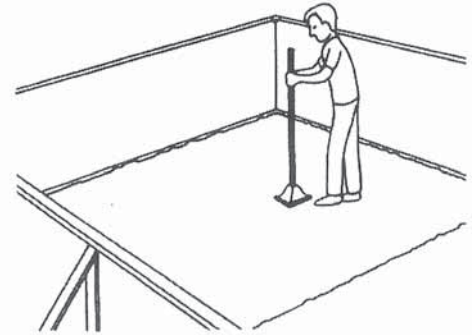

## PLACEMENT OF SAND/CEMENT MIXTURE

To save effort when adding the sand/cement or pool base mixture, dump it near the area to be troweled. A certain amount will roll down, but it is easily re-positioned when made to the right consistency. Particular care should be taken with the troweling of the bottom. The smoothness and evenness of the bottom will determine the appearance of the liner when it is placed in the pool. (There must be NO exposed aggregate)

In order to get maximum compaction and surface smoothness, only thoroughly washed, mason sand (DO NOT USE RIVER SAND) should be mixed with cement in a 5-to-1 (sand-to-cement) ratio. This will allow the finishing operation to proceed smoothly. Inspect the sand finish for sharp, oversized aggregate.

**Note: If pool base is used, follow manufacturer's instructions. Both sand/cement and pool base must be mixed using a mixer.**

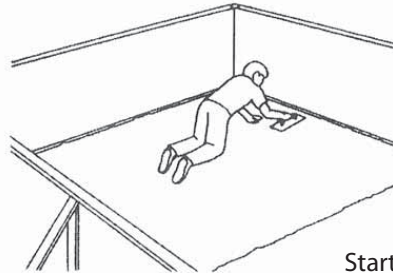

Starting in the hopper end, bring the pool bottom up to finish grade with a damp sand/cement mixture, or pool base mixture. Trowel smooth.

## How Much Sand And Cement?

The correct sand-to-cement ratio is 5-to-1. The example below should help.

1. Calculate the surface area of the pool. (Example:  $20' \times 40' = 800$  square feet)
2. Multiply by 15% (.15). (Example: 120)
3. Add lines 1 and 2 to arrive at the area to be covered by sand/cement. (Example:  $800 + 120 = 920$  square feet)
4. Divide line 3 by 162. This will tell you how many cubic yards of sand you'll need. A cubic yard of sand is equal to one ton in weight. Some suppliers will sell by the cubic yard and some will sell by the ton. (Example:  $920 \div 162 = 5.7$  cubic yards, or 11,400 pounds)
5. Divide the pounds of sand by 5 to arrive at the 5-to-1 ratio. This will determine how much cement you need. (Example:  $11,400 \div 5 = 2,280$  pounds)
6. Divide line 5 by 94 pounds. Most bags of cement are 94 pounds type II (2) Portland cement. This will tell you how many bags of cement you'll need. (Example:  $2,280 \div 94 = 24.3$  bags)

**NOTE:** Always order a few extra bags of cement. Return what you do not use. If you have any extra sand, use it in plumbing trenches.

## VINYL LINER INSTALLATION

### General Information

Vinyl liners should be stored in areas with temperatures above 50°F to prevent excessive shrinkage and permanent folds in the vinyl.

### Cold Weather Installation

When installing a liner in temperature of 65°F or lower, store the liner at 70°F to 80°F for at least 72 hours prior to installation. When the bottom is finished, bring out the liner and drop it as quickly as possible. Try to drop the liner in direct sunlight to help seat it properly. Do not leave a boxed liner exposed to the elements.

### Tools Needed For Liner Installation

Commercial vacuum(s) (MightyVac recommended)  
Screwdrivers, Phillips and straight  
Razor knife

Garden Hose  
Broom  
Two to four people

### Liner Installation

Vinyl liner installation can be fast and easy; just follow these guidelines!

1. Before you begin installing the liner, insure that the pool bottom is free of any stones, sticks and footprints. Vacuum with shop-vac thoroughly.
2. Use duct tape to tape all panel joints.
3. Use caulk to secure gaskets to the main drain and skimmer.
4. Insure liner track is clean and free of any sand, concrete, etc.
5. If steps are used, refer to the STEP section before continuing with liner installation.
6. Place the liner box at the deep end of the pool, with arrows facing the right direction. Open liner box carefully, be cautious with sharp knives or box cutters that could puncture the liner. Carefully unfold the liner. Have two people take the shallow-end corners and pull the liner to the shallow-end (see Figure 22), keeping the liner away from any sharp edges. **AVOID DRAGGING THE LINER ACROSS THE POOL BOTTOM.**

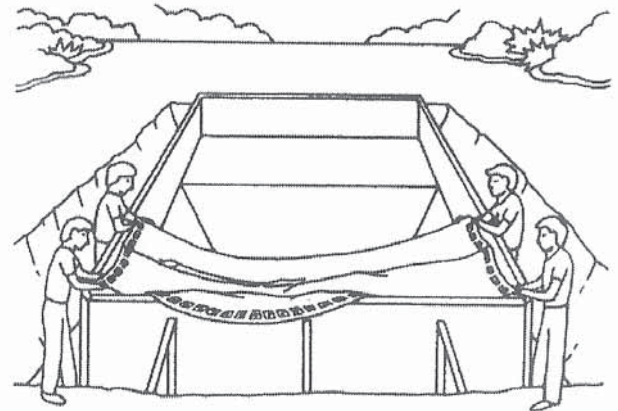

Figure 22: Liner Unfolding

7. From the outside of the pool, snap the liner bead into the liner track in each shallow-end corner (see Figure 23). Continue snapping the bead into the track across the shallow end of the pool. Now, start down the long sides, toward the deep end. Several feet past the break point, stop and square the liner over the break point, using the seam as a guide. When the liner is square, continue snapping the bead into the track, being careful not to overstretch the liner. Push the liner bead into the liner track completely to insure proper locking.

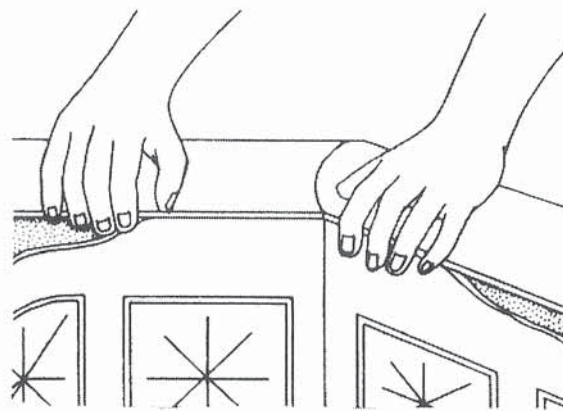

Figure 23: Liner Bead Installation

8. After the liner bead is completely installed in the liner track, adjust the liner in the pool corners, as required, to achieve a smooth, loose fit in the corners. Do not stretch the liner tightly over inside corners.

Make sure there is enough material in the shallow end to allow the vinyl liner to rest against the entire shallow-end wall containing the step with NO space between the liner and the step at the floor. The material needs to be flat against the step area. Place sand bags (you should have several for the filter) across the entire shallow-end wall if necessary. The material in this area has to stay in place. The deep end of your liner has more material than the shallow. It is designed to stretch.

9. When the liner is positioned correctly, remove a small area of the liner bead from the liner track, close to the break point, and insert approximately 36" of vacuum hose behind the liner. **DO NOT ALLOW THE VACUUM HOSE TO TOUCH THE POOL BASE!** Use duct tape to tape the hose in place and seal the opening around the hose to create a vacuum behind the liner. NOTE: Larger pools may require two vacuums.
10. Turn on the vacuum(s). As suction starts to pull the liner down, continually adjust the fit by pulling the excess material on the floor toward the base of the pool walls. If you can't get all the wrinkles out, shut off the vacuum(s), reposition the liner in the pool, turn the vacuum(s) back on and start the process again.
11. When the liner is pulled down snugly, with no wrinkles, you are ready to finish installing the main drain. By feel, locate the screw holes in the top of the main drain, under the liner. With the gasket in place, screw the faceplate to the main drain, following the manufacturer's instructions. CAREFULLY, use a razor knife to cut out the liner material INSIDE the main-drain frame and install the main-drain cover.
12. Using a standard garden hose, place the hose end in the hopper and start water flow. Once there is 1' to 2' of water in the hopper, the remainder of the pool can be filled from the garden hose or a water truck. **DO NOT ALLOW A STRONG STREAM OF WATER TO DIRECTLY HIT THE POOL BOTTOM.**
13. When the water is 6" deep in the shallow end, remove the vacuum(s) and the sand bags. Install the liner bead in the liner track. If steps are used, install the step faceplate now (see Figure 24).
14. When the water is at least 12" to 18" deep in the shallow end, locate the returns and the skimmer(s). Install the gaskets/faceplates, following the manufacturers' instructions. Carefully, use a razor knife to cut out the liner material INSIDE the returns and skimmer(s).

15. DO NOT REMOVE THE VACUUM(S) WITH LESS THAN 6" OF WATER IN THE SHALLOW END AND DO NOT ALLOW THE VACUUM(S) TO RUN WITH MORE THAN 12" OF WATER IN THE SHALLOW END. IF THE VACUUM(S) ARE SHUT OFF FOR ANY REASON BEFORE THE WATER IS 6" DEEP IN THE SHALLOW END, THE WATER MUST ALSO BE SHUT OFF UNTIL THE VACUUM IS RESTORED.

## SWEETWATER STEP AND SWIM-OUT LINER INSTALLATION

Using a thin piece of plywood, cover the top of the step section. Mount a piece of coping to the wood so that the liner will maintain a straight profile over the step. Use duct tape to seal the wood over the steps and seal all openings around the liner. When the water is 6" or more in the shallow end, install faceplates, using stainless-steel screws and following the manufacturer's instructions. Carefully use a razor knife to cut out the liner material inside the step faceplates. Install screw covers following the manufacturer's instructions. Trim the vertical faceplate to meet the bottom of coping.

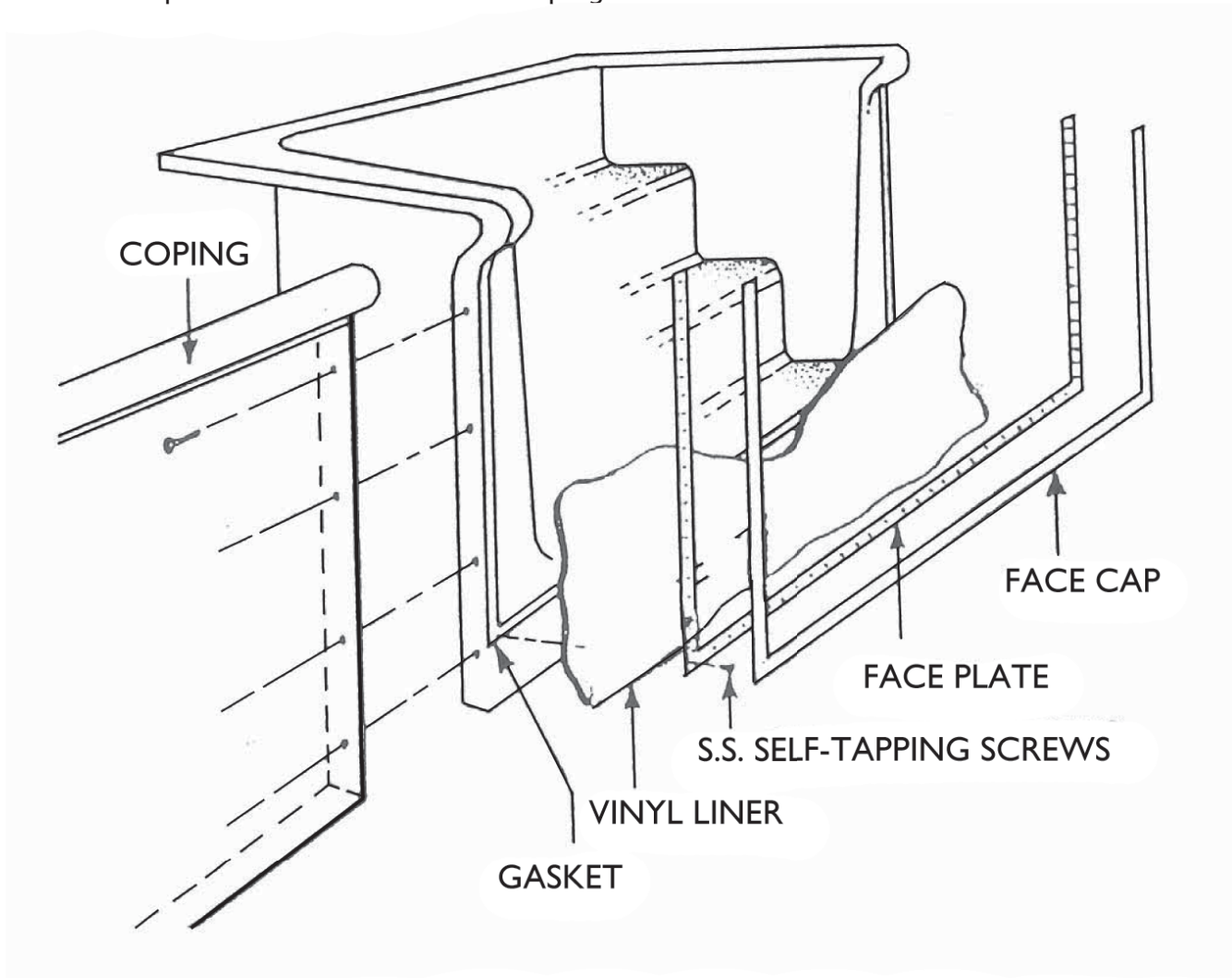

Figure Step

## BACKFILLING YOUR HYDRA POOL

There are several methods used in backfilling the pool. One method is to backfill as the pool is being filled with water, keeping the water level even with the backfill material. The backfill material should be placed in layers and kept even all around the pool. **USE ONLY NON-EXPANSIVE MATERIALS FOR BACKFILL (SAND, CRUSHED STONE, ETC.). DO NOT USE CLAY, DIRT, SOIL, OR OTHER EARTHEN MATERIALS FOR BACKFILL.** Bring the backfill grade to the top of the braces, leaving the brace top exposed.

## INSTALLING CONCRETE DECK

1. Insure the tops of the braces are exposed so the concrete can bond to the brace.
2. Insure the coping clips are installed over the coping joints. Use painters tape to completely cover the face of all coping, protecting it from splashing concrete.
3. Concrete should be a minimum of 6" thick at the pool edge and taper down to 4" on the outer edge.
4. For proper drainage, the slope must fall 1/4" for every 1' of width.
5. Install ladder/handrail anchors, as required, when forming deck. Follow the manufacturer's instructions.
6. Insure concrete completely fills the coping.
7. Insure concrete completely fills the gap under the lip of the step to provide additional structural support.
8. Broom-finish the concrete for a non-slip surface or apply other concrete toppings, such as cool deck.
9. Edge and groove the expansion joints or use expansion-joint material. Do not position expansion joints directly over the pool wall braces.
10. Use additional support (piers) down to undisturbed earth when the deck extends more than 4' from the pool wall.
11. Pour the deck at least 8' wide where the diving board is installed.

## SAFETY ROPE

Use the APSP Guidelines to determine the correct position for the safety rope. Install coping-mounted rope eyes in this position and fasten the safety rope, following the manufacturer's instructions.



## Detail Drawings

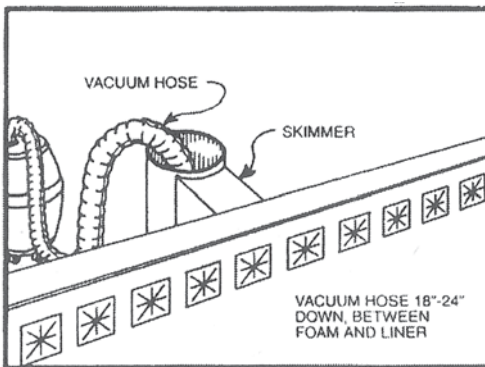
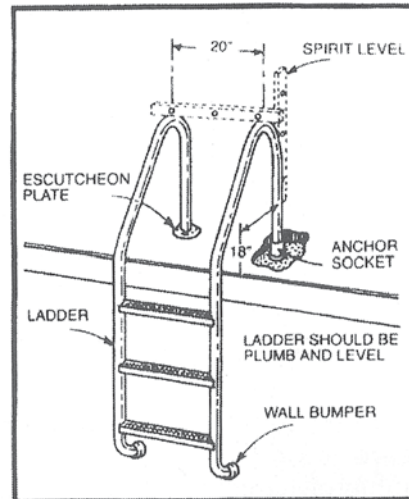
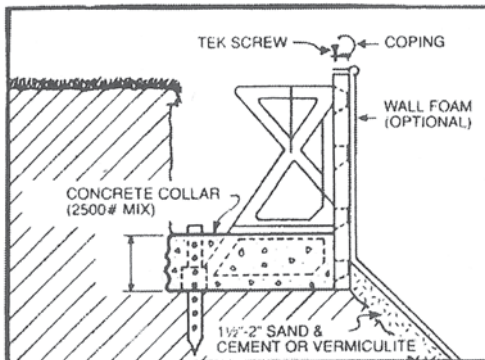

As soon as the liner is pulled into place, start filling the pool. Leave vacuum on until water is 6" deep in the shallow end.

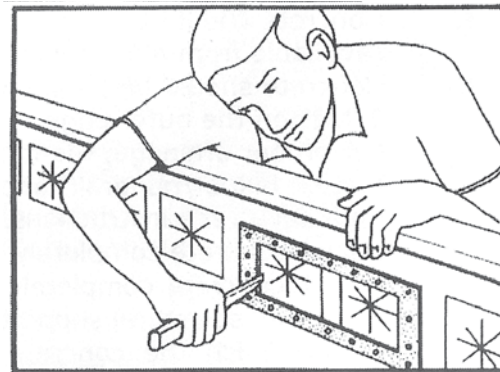

When water level is 2' above panel bottoms, screw skimmer, returns, and light faceplates with gaskets to wall fittings. Using a knife, carefully cut out vinyl from inside faceplates.

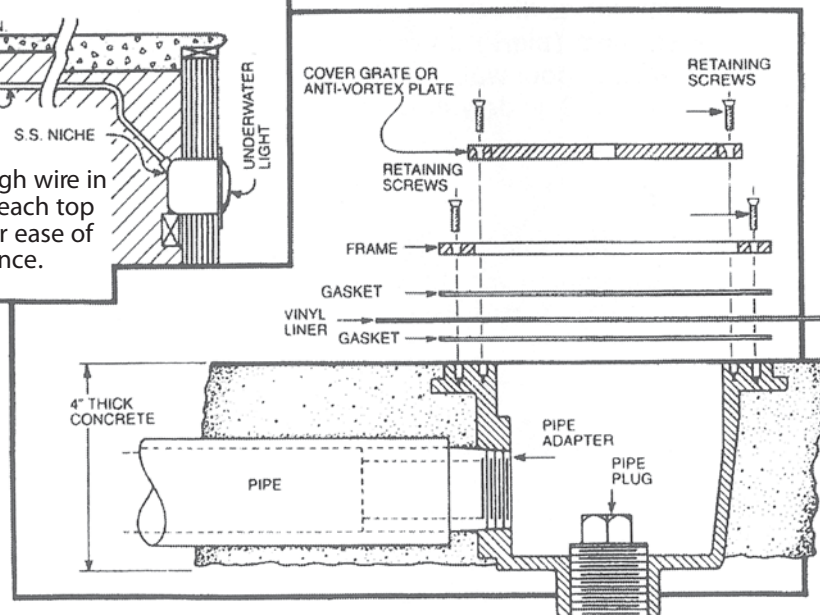
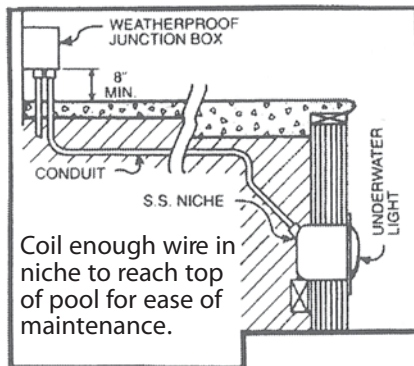

The main drain should be mounted in a concrete pad approx. 24" x 24" x 4" thick. The piping from the main drain should be installed and run out from pool area before pouring concrete bond beam around pool.



## Pool Plumbing Schematic

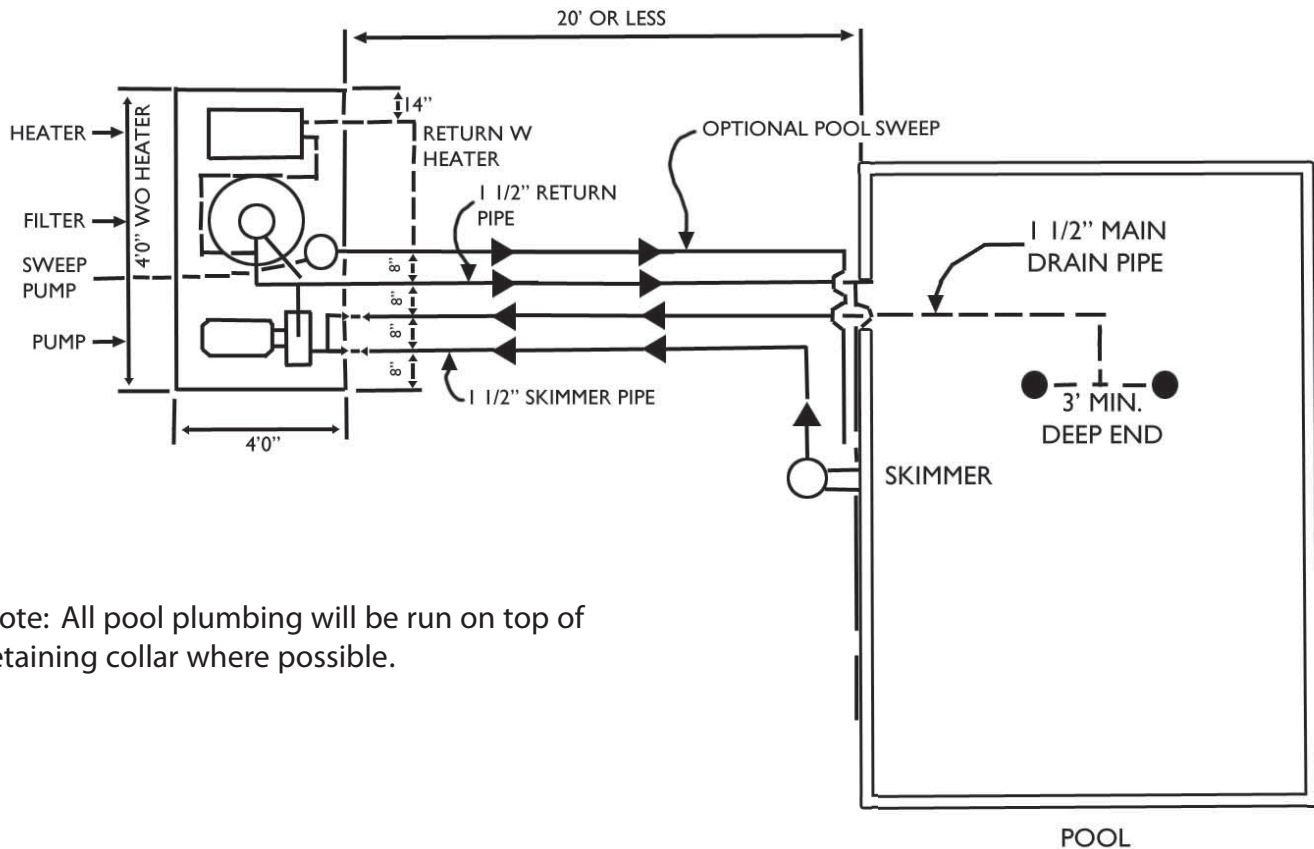

Note: All pool plumbing will be run on top of retaining collar where possible.

## NOTES:

- Polystyrene is not designed to be exposed to UV rays for a long period of time. Panels should be covered (back-filled) within a one-to two-week period from excavation.
- All plumbing lines should be installed at ground level (in overdig area) to eliminate stress from back-fill. Do not hang plumbing.
- Valve all suction and return lines independently.

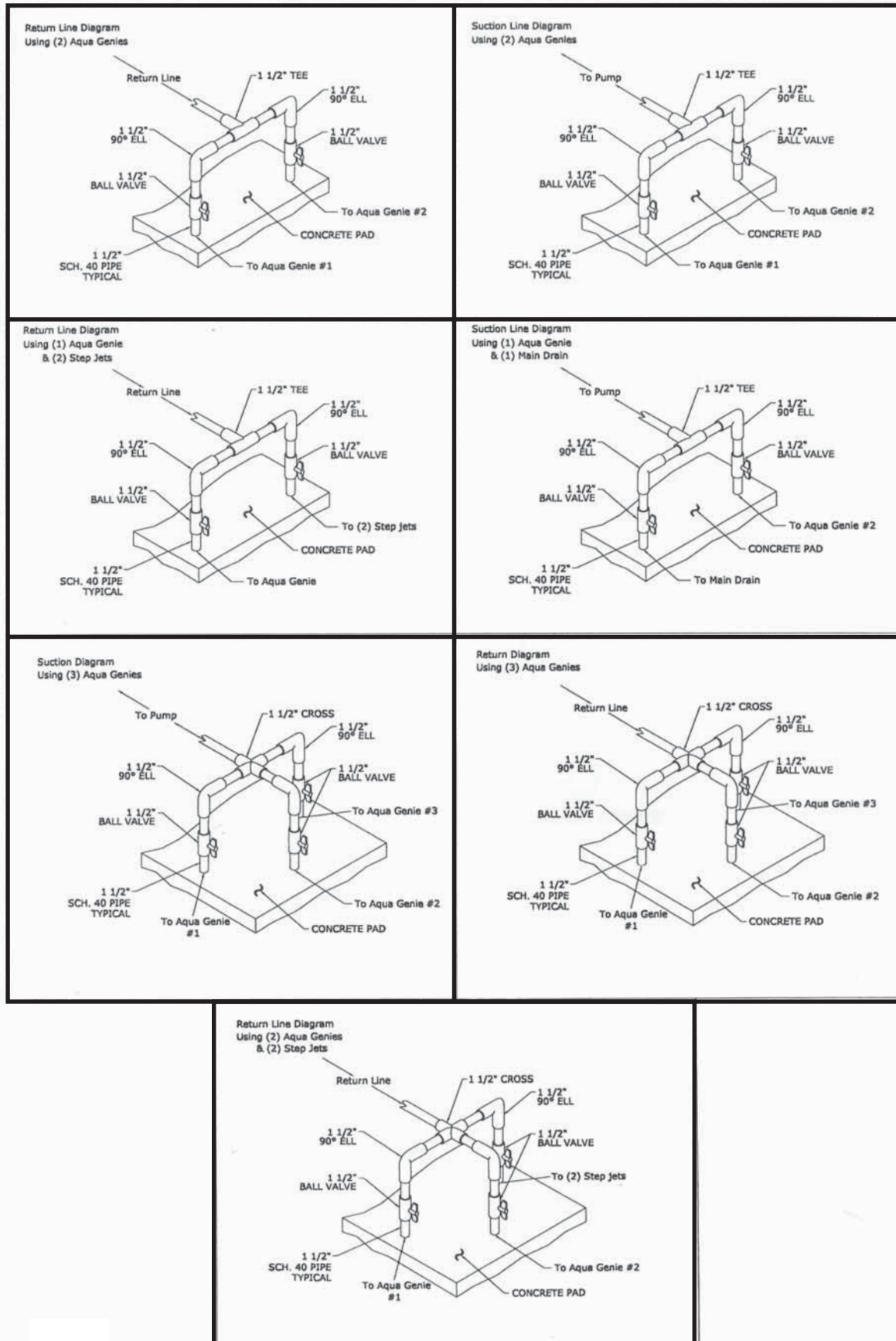

## FREQUENTLY ASKED QUESTIONS

### Excavation Questions

Q. How deep should I excavate the shelf/shallow end of the pool?

A. Once you establish the pool elevation/benchmark, excavate 42" down, which is the height of the Hydra, Pinnacle, or Cornerstone polymer or Samson steel panel without the coping attached. This is depth of the shelf around the entire pool where the panels will sit. This shelf is the same in the shallow end as well as the deep end. The entire shallow end should be excavated to the same depth as the shelf. You will constantly be using two terms, dig dimensions and finish dimensions. Be sure you understand both terms and how to move between them during the construction of your pool.

Q. How deep should the hopper in the deep end be excavated?

A. Always dig the hopper in the deep end 2" deeper than the pool's finish depth. Example: If the finish depth of deep end is 8', dig hopper area to a depth of 8'2" from the benchmark or the top of the 42" panel without coping installed. This will allow for the installation of 2" of bottom material, such as vermiculite (pool base) or sand-and-cement mixture in the bottom of the hopper.

Q. Will excavating the shelf area around the pool leave enough room for the braces?

A. The panel line you have will dictate the brace size and the amount of overdig in the shelf area. Requirements are as follows: Hydra requires a 24" overdig, Cornerstone requires a 24" overdig, Pinnacle requires a 36" overdig, Samson Steel requires 30" overdig, Extreme requires a 24" overdig. These are minimum requirements to allow room for the brace and to work in the shelf area.

Q. The installation manual advises not to over dig, what does this mean?

A. Extreme care should be taken when digging any depth or slope of the pool, especially in the hopper or deep end of the pool. Carefully mark the shelf area where the walls will sit using marking paint or strings with pins. Do not let the excavator dig past your marks or strings. You may want to hand shovel (trim) during this procedure to keep the excavator away from the shelf, thus keeping the shelf edge intact where the walls will sit. Keep in mind that all walls in the hopper area slope at various angles, thus the term "hopper bottom".

Q. When digging and encountering ground water, what are some options?

A. The most common option is to use a self-priming pool pump like the one for your pool package. All plumbing should be schedule 40 PVC installed as shown in the installation manual. Cap the pipe and drill as many 3/8" holes as possible in the tailpiece buried in the gravel/rock below grade. Make sure all plumbing joints are tight so you can pump the maximum amount of ground water from beneath the pool during the construction of the pool.

## Finish-Dimensions Questions

Q. What do finish dimensions refer to?

A. Finish dimensions refer to several areas of the pool. Most of the time they refer to the interior of the pool, both length and width, as well as depth measurements. Example: A 16' x 32' rectangle pool that is 40" finish in the shallow end and 8' finish in the deep end would measure 16' wide and 32' long on the interior of the pool walls. The depth of the pool would be measured from the top of the wall (without coping attached) to the finish bottom material. The bottom material comes 2" up the wall panels to the finish grade following the entire inside perimeter of the pool. Panels have a scribed line at the 2" mark.

Q. What standard dimensions are on the drawing you receive with your package?

A. All dimensions on your drawing are finish dimensions, with the exception of the panel-shelf detail. Remember to add 2" to all depth dimensions to allow for the 2" of bottom material needed later. This applies to the panel shelf as well. The panels are 42" high, and the finish inside the pool is 40", up 2" on the panel. All depth measurements are from the top of the panel with no coping installed.

## Panel-Installation Questions

Q. How tight should the panel bolts be?

A. All panel lines need to have the bolts tight and secure. Do not over tighten. Two of the panel lines (Hydra and Cornerstone) have side flanges that are smooth and require using the alignment bolt to properly connect one panel to the next. One of the panel lines (Pinnacle) has stud/socket alignments on the side flanges of every panel. This allows for instant panel alignment and lateral strength.

Q. How level should the panels be?

A. As with any construction project involving walls and footing, the walls need to be level, square and plumb (perfectly vertical) before the footer/collar is poured. After the panels are bolted together, they need to be leveled by using the transit to level all panels to every other panel. While this step is progressing, continue to square the pool also. After the pool panels are level and square, make sure they are plumb. After this is complete, and after the braces are all set, it is time for the collar to be poured.

Q. How do I bolt the panels to the step, in-wall ladder, cozy cove spa or swim out?

A. After leveling the step following the manufacturer's instructions, clamp the wall panel to the steps so that the flanges on the side of the step align with the top and face of the panel. If wall stiffeners are in your way, mark all holes with a marker, remove step from panels and drill holes where marked on step flanges. Remember, one panel line has an alignment feature on one side that must be removed at this time so the steps will bolt up flush to the panel. The Hydra and Cornerstone panels do not require this step.

Q. My soil is too rocky or hard for the polymer stakes, what can I use?

A. Steel stakes are available as an up charge on all panel lines. Hydra, Cornerstone-H02466,Pinnacle-H03110.

Q. What consistency should the concrete for the collar (bond beam) be?

A. When ordering concrete for the bond beam/collar, it should be 3,000 psi rating with a minimum of 5" slump. This allows the concrete to flow around the braces.

NOTE: Always check walls for straightness and plumb before concrete sets.

## Aqua Genie Installation Questions

Q. How is the Aqua Genie installed?

A. The Aqua Genie is mounted from the back of the panel with the face of the Aqua Genie extending through the precut hole in the panel. It attaches to the back of the wall using eight number-10x3/4" self-tapping screws.

Q. The Aqua Genie has three holes for plumbing lines, which goes where?

A. There are two holes below the point at which the basket sits in the main body of the Aqua Genie. One is 1-1/2" and the other is 2". One will be your suction going to the front of the pump, located at the equipment pad. The other will be plugged in such a manner to insure a watertight seal. The third hole is located under the throat of the Aqua Genie; this is where the clean filtered water returns from the filter. Two terms used often in the pool industry are suction and return. The pump located at your equipment pad is the center point. If you are standing over the pump, any plumbing lines coming from the pool to the front of the pump are called suction lines. Any lines leaving out of the top of the pump to the filter, heater, salt generator and the like and eventually going back into the ground and back to the pool are called return lines. We have suction lines and return lines.

Q. Where should the Aqua Genie be placed in the pool perimeter?

A. Always locate the Aqua Genie as close as possible to the center of the long wall on a rectangle pool. Larger rectangle pools may require two, L-shaped pools may require two or more, and free-form pools have specific requirements that are noted on your layout drawing.

Q. Where do I order replacement parts?

A. [WWW.aquagenie.com](http://WWW.aquagenie.com) for any replacement parts. An exploded view with a BOM is provided.

Q. How do I pressure test the Aqua Genie?

A. Place expanding plugs in the bottom on the suction line. Place a blanking plate on the the nozzle and plug the stainless steel feeder tube. Fill the lines with air and check the guage for any drop in pressure.

Q. How do I winterize the Aqua Genie?

A. We recommend using our Aqua Genie winter cover, part 3-H03116N. This covers the inlet and return of the Aqua Genie. With this cover there is no need to remove the faceplate. Place the covers bolt through the inlet and tighten until the gasket is snug. Blow out the plumbing lines to remove all of the water. Pour a couple of gallons of RV antifreeze into the suction line underneath the basket.

Q. Why don't I need seperate returns when using the Aqua Genie?

A. The Aqua Genie has a built in return.

Q. Where should the Aqua Genie be placed in the pool?

A. Always locate the Aqua Genie as close as possible to the center of the long wall on a rectangle pool. Larger rectangle pools may require two, L-shaped pools may require two or more, and free-form pools have specific requirements that are noted on your layout drawing.



## Step-Installation Questions

Q. How do I support my Sweetwater Steps during installation?

A. Your steps come with our new PVC and ABS step-alignment system. This is your leveling system to support the step during and after installation. This leveling feature attaches PVC legs to the injection-molded tread support mounted under the step treads. The legs will be anchored in the concrete collar when poured around the pool perimeter. With the proper backfill installed, this should give you a lasting foundation for your steps.

Q. When I install coping up to the side of the step, the vertical faceplates on each side of the steps get in the way. What should I do?

A. Cut the vertical faceplate and beauty strip off about 1/2" below the liner track on the coping. This will allow the coping an easy transition from the top of the wall to where it butts up to the side of the step.

Q. When should I remove the faceplate extrusions from the step?

A. Leave them attached until you are ready to install the liner. Remove the beauty strip, and before removing the faceplates, mark right/left and top. The horizontal strip across the bottom of the step should be marked right and left also. **THEY CAN BE REINSTALLED INCORRECTLY.** All screw holes are pre-drilled to match the faceplate. The gasket is installed and covers the pre-drilled holes. You will want to align them perfectly when installing the strips over the liner.

Q. Where should I place the step returns if installed?

A. Installation should be on the flat area on either side of the step, as you walk down into the pool. Placement should be about 12" to 15" down from the top of the step. This fitting is #SP1023. This fitting has three gaskets, two rubber gaskets and one fiber gasket. The hole size for the step return is 2-1/2".

Q. When should I put the faceplates on to secure the liner to the step?

A. The water in the pool (shallow end) should be deep enough to push the liner vertical to the step. The liner at the bottom of the step should be at a 90° angle from the floor to the step, no space. Once this has been accomplished, attach one vertical faceplate and then the other vertical faceplate to the step. Tighten and secure each screw. Once this has been done, install the horizontal faceplate. If there is any doubt as to how the faceplates are to look when installed, take a picture before removal, showing step detail with beauty strips removed.

Q. How do I support my Sweetwater 6' swim out?

A. The width tread of the 6' swim out has a large surface area. Due to the weight of the water on this area it is best to support it with concrete block piers. Place 4 piers across the bottom length of the swim out, where the blocks touch the bottom of the swim out. Place a treated or composite board across the whole length. When the collar is poured this will keep the blocks in place.

Q. How do I clean the steps and swim outs?

A. You can clean the steps and swim outs with a soft scrub cleanser with bleach. For stubborn stains you can use an automotive rubbing compound.

Q. I need to replace my step screws, gasket, and faceplates. What parts do I need to order?

A. The step screws are number 10 x 1" pan head stainless steel. The replacement screws are part number H01906 sold in a pack of 50. The faceplates and gaskets can be ordered and they are part numbers H0543UD for the faceplates and I02631 for the gaskets (2 required for an 8' step), holes are not pre-drilled. Use the old faceplates as a guide to drill the new faceplates.

Q. How do I winterize step/swim out jets or main drain?

A. Remove the internal jet. Carefully turn the jet with slow even pressure, USE CAUTION WHEN TURNING THE JET, TO MUCH FORCE WILL BREAK THE INTERNAL TABS AND A NEW JET WILL BE NEEDED. Place expanding rubber plugs in the jet openings. Remove or open the air valve all the way. Blow air through the lines until the water is removed. For the main drain blow air until you see bubbles coming from the drains, quickly close the valve at pump. Pour RV antifreeze through the air valve and close.

## Coping-Installation Questions

Q. Do I need to cut the coping to fit?

A. Both our bull-nose and cantilever coping require some cutting to fit. This can be done with a hacksaw, sawzall, jigsaw or a compound miter saw with a metal cutting blade.

Q. Some of the coping clips pop off. How can I correct this?

A. Make sure the joint where the coping sections meet is even. You may have to tap one or the other with the palm of your hand to align them evenly. Take the coping clip and bend it slightly into a tighter radius. Take a small amount of clear silicone and apply to the inside of the clip before installation.

Q. I have cantilevered coping. Where are my coping clips?

A. Cantilever coping does not require clips. You will need self-tapping screws only.

Q. During installation, my coping was scratched. How could I repair the finish?

A. This can be touched up with paint supplied where you purchased your pool kit. It is a specially formulated paint for the coping. It is sold in 12 oz cans and the part number is HO2974.

Q. Can I tape the coping to protect it when pouring the deck?

A. Painters tape can be used along the coping edge. Apply just prior to pouring the deck. If there is adhesive transfer, use a rag and a product called GOOP or GOO GONE to remove. This is available at most major home-improvement centers.

## Liner-Installation Questions

Q. My liner is either too big or too small?

A. Vinyl liners are temperature sensitive. If it appears too big, take the liner out of the track and let it relax in the bottom of the pool. Wait until the early morning to re-install the liner. If the liner appears small take it out of the track and let it relax. Wait until mid afternoon to re-install the liner. In the fall, winter, or early spring keep the liner in a heated area until ready to install.

Q. My liner bead will not stay in after I installed, what can I do?

A. An extruded product known as liner lock is available to assist in keeping the liner in the liner track and it is widely available online and in most pool stores.

Q. I need to know the gallons of my pool?

A. Go to [www.hydrapools.com](http://www.hydrapools.com) and look under the resources tab to find our gallon calculator.

Q. I need to patch/repair my liner, what should I use?

A. Most pool supply or some home improvement stores will carry a pool vinyl liner repair kit. You can also find these kits online.

Q. I ordered a safety ledge and I do not see it on my pool?

A. Sometimes with our liner design software, the safety ledge is designed into the pool, this eliminates seam.

Q. Where do I find the serial number for my liner?

A. The serial number will be on the warranty card and on the liner. Look in the deep end, on the back of the liner, it will be placed 1'-2' from the center of the deep end near the top of the liner.

Q. How do I line up the liner of a free form pool?

A. Look for the seam at the back of the hopper where it meets the slope. Use this to line up the deep end. For the shallow end look for a seam closest to the break, it will be parallel.

# HYDRA

P O O L S

a division of PI, Inc.



## Developing Ideas into Quality Products

At Plastic Industries, we've been molding products from plastic resin for over 55 years. During that time, we have established ourselves as leaders in molding technology and structural-part design.

Now we bring this technology and experience to the swimming-pool industry with our Hydra Pool Panels, Braces, Steps, and Liners.

[www.hydrapools.com](http://www.hydrapools.com)

Rev. Level: A  
Rev. Date: March 9, 2011  
Document ID: QOP756 Polymer/Steel  
Installation Manual

### Hydra Pools

543 S. Main Street	21822 Hwy J46
Sweetwater, TN 37874	Centerville, IA 54544
1.800.894.4876	1.866.518.4181